



Model:
CAT-GC2801B

28 IN. 1-DRAWER 2-DOOR BASE CABINET

Instruction Manual

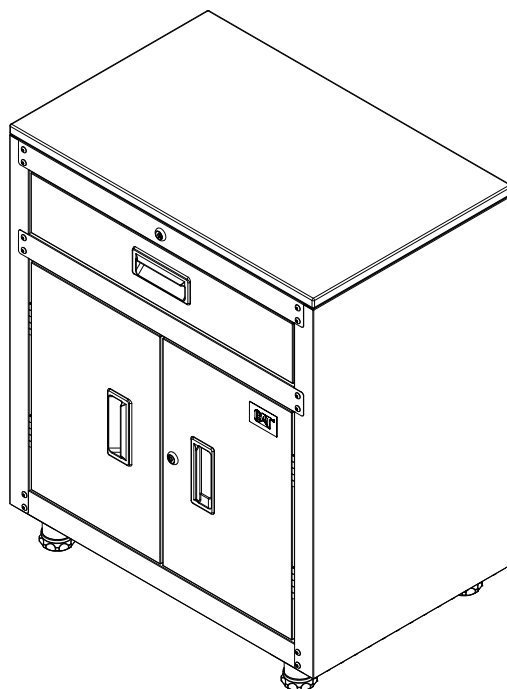

TABLE OF CONTENTS

CABINET SAFETY.....	2	ASSEMBLY INSTRUCTIONS.....	5
DIMENSIONS	3	DRAWER REPLACEMENT.....	12
LOAD CAPACITY	3	MAINTENANCE	12
PARTS.....	4	CARE AND CLEANING.....	12
TOOLS REQUIRED FOR ASSEMBLY.....	5	WARRANTY.....	13

CABINET SAFETY

Your safety and the safety of others are very important.

We have provided many important safety messages in this manual and on your appliance. Always read and obey all safety messages.



This is the safety alert symbol.

This symbol alerts you to potential hazards that can kill or hurt you and others.

All safety messages will follow the safety alert symbol and either the word “DANGER” or “WARNING.”

These words mean:

 **DANGER**

You can be killed or seriously injured if you don't immediately follow instructions.

 **WARNING**

You can be killed or seriously injured if you don't follow instructions.

All safety messages will tell you what the potential hazard is, tell you how to reduce the chance of injury, and tell you what can happen if the instructions are not followed.

To reduce the risk of serious injury, read and follow the safety instructions below before assembling and using this product.

- This product is intended for indoor use only.
- This product is not designed for commercial nor industrial usage.
- Solid wood refers to rubber wood.



WARNING: Use at least two people to move, assemble or install this product. Failure to do so can result in personal injury or product damage. Any assembly or maintenance of the product must be carried out by adults only.



WARNING: DO NOT alter this product in any manner. For example, do not weld external bar locks or attach electrical equipment. This may cause product damage or personal injury.



WARNING: Check all nuts and bolts periodically for tightness. When required, tighten them again.



WARNING: DO NOT leave children unattended near this product. Cabinet may tip over if improperly opened.



WARNING: Close and lock the doors before moving this product.



WARNING: Keep the product on level surfaces. The product could become unstable and it may tip over if stored or moved on an uneven surface, which may cause personal injury, death or product damage.



WARNING: Wear safety glasses when removing or repositioning the slides. The tool could slip, causing personal injury. Close and lock the drawers before moving the cabinet.



WARNING: DO NOT stand on the product or lean on the drawer or wood top.



WARNING: It is always recommended to secure this product to the wall with the anti-tip hardware provided.



WARNING: Do not exceed the recommended weight limits.



WARNING: Evenly distribute the weight on each level and always keep the heavier loads on the bottom.



WARNING: Before cutting, drilling or hammering into any wall or floor surface, verify the location of electrical, plumbing and gas lines. Cutting may cause serious injury.

DIMENSIONS

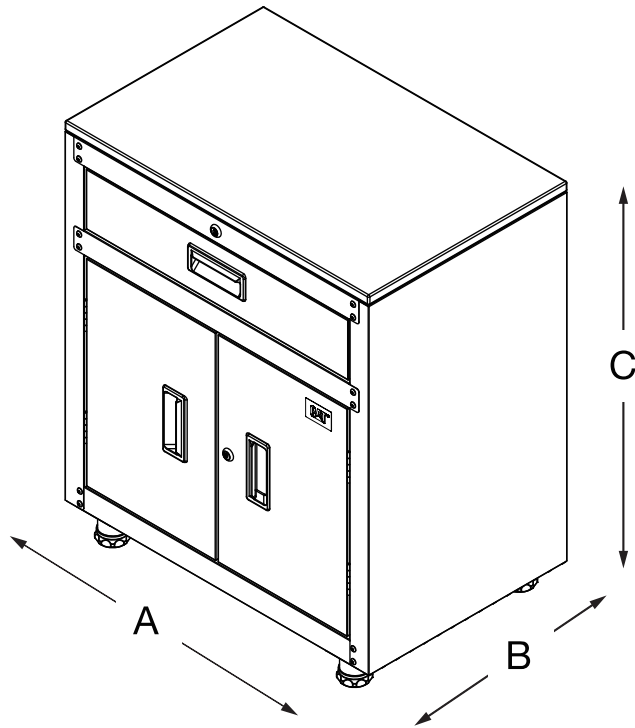

Model	CAT-GC2801B
A	28" (71.3 cm)
B	18.3" (46.6 cm)
C	32.8" (83.4 cm)

LOAD CAPACITY

Maximum load for drawer	50 lb / 22.7 kg
Maximum load for shelf	100 lb / 45.4 kg
Maximum load for bottom panel	100 lb / 45.4 kg
Maximum load for wood top	100 lb / 45.4 kg
Maximum total load	350 lb / 158.9 kg

PARTS

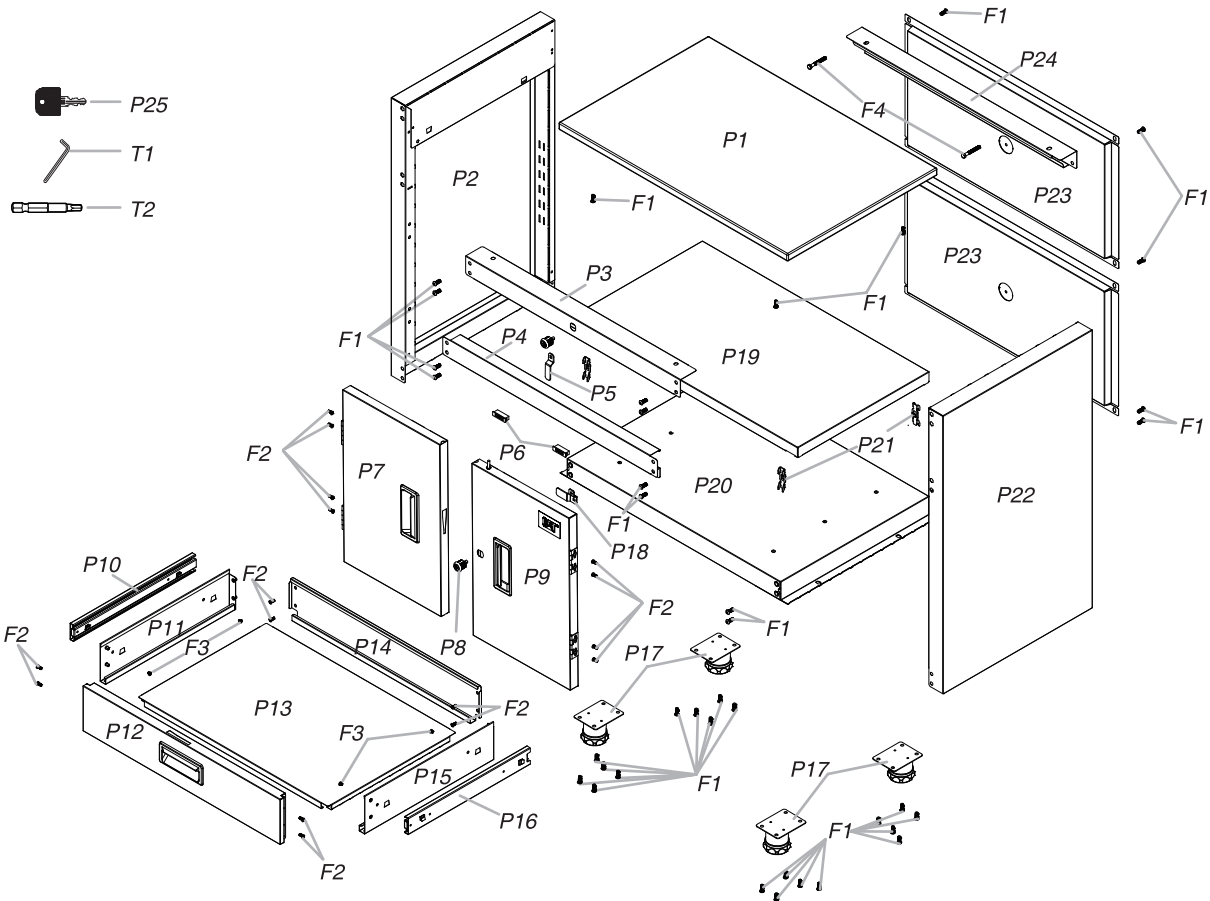

Ref#	Description	Part #	Qty
P1.	Solid wood top	307040	1
P2.	Left side panel	124759	1
P3.	Front top beam	124761	1
P4.	Front center beam	124762	1
P5.	Locking hook	241141	1
P6.	Magnet	312033	2
P7.	Left door	124764	1
P8.	Lock	304279	2
P9.	Right door	124765	1
P10.	Slide L	300371	1
P11.	Drawer left panel	124767	1
P12.	Drawer front panel	124763	1
P13.	Drawer bottom panel	247057	1
P14.	Drawer back panel	247060	1
P15.	Drawer right panel	124766	1
P16.	Slide R	300372	1

Ref#	Description	Part #	Qty
P17.	Adjustable foot	313066	4
P18.	Locking hook	247029	1
P19.	Shelf	245787	1
P20.	Bottom panel	123849	1
P21.	Shelf bracket	243311	4
P22.	Right side panel	124760	1
P23.	Back panel	245788	2
P24.	Back top beam	245789	1
P25.	Key	304196	4
T1.	Hex wrench (hex key)	317023	1
T2.	Hex screwdriver bit	317024	1
F1.	M6 x 16 hex socket head screw	320327	44
F2.	M4 x 12 cross-shaped flat head screw	320084	16
F3.	M4 x 5 Phillips head bolts	320336	4
F4.	M6 x 40 hex tapping bolt	320328	2

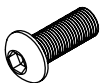

F1



F2



F3

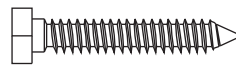

F4

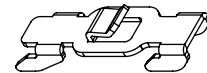

P21

TOOLS REQUIRED FOR ASSEMBLY

Gather the required tools and parts before starting installation.

Tools Needed

- Hex wrench (hex key)
- Hex screwdriver bit (Optional)
- Measuring tape (Not included)
- Power driver (Optional, not included)
- Gloves (Not included)

ASSEMBLY INSTRUCTIONS

1. Attach the side and bottom panels

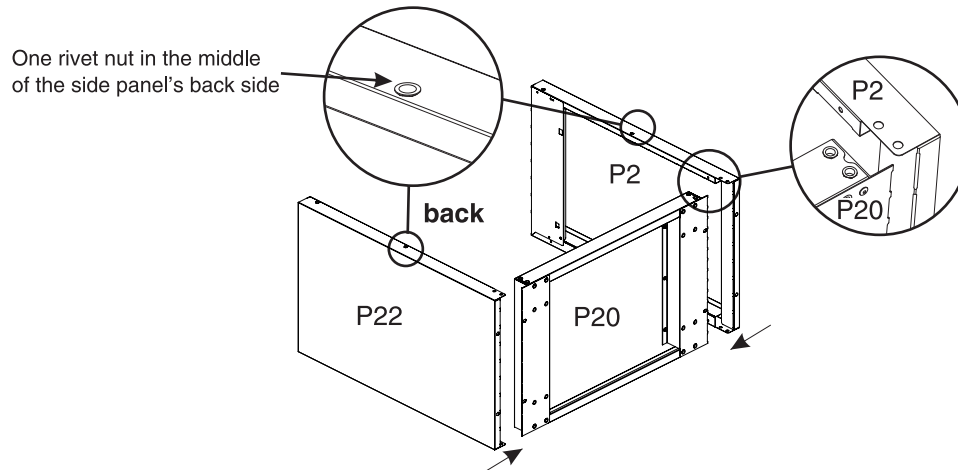

- Attach the side panels (P2 & P22) and bottom panel (P20) together.

2. Attach the side and bottom panels

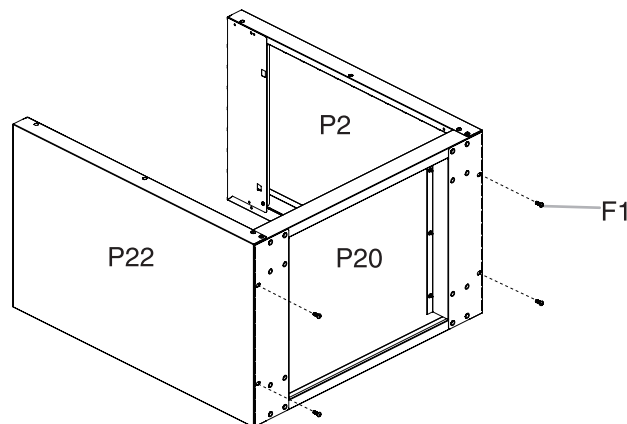

- Connect the side panels (P2 & P22) and the bottom panel (P20) with four M6 x 16 hex socket head screws (F1) at the bottom. Tighten securely.

3. Attach the adjustable feet

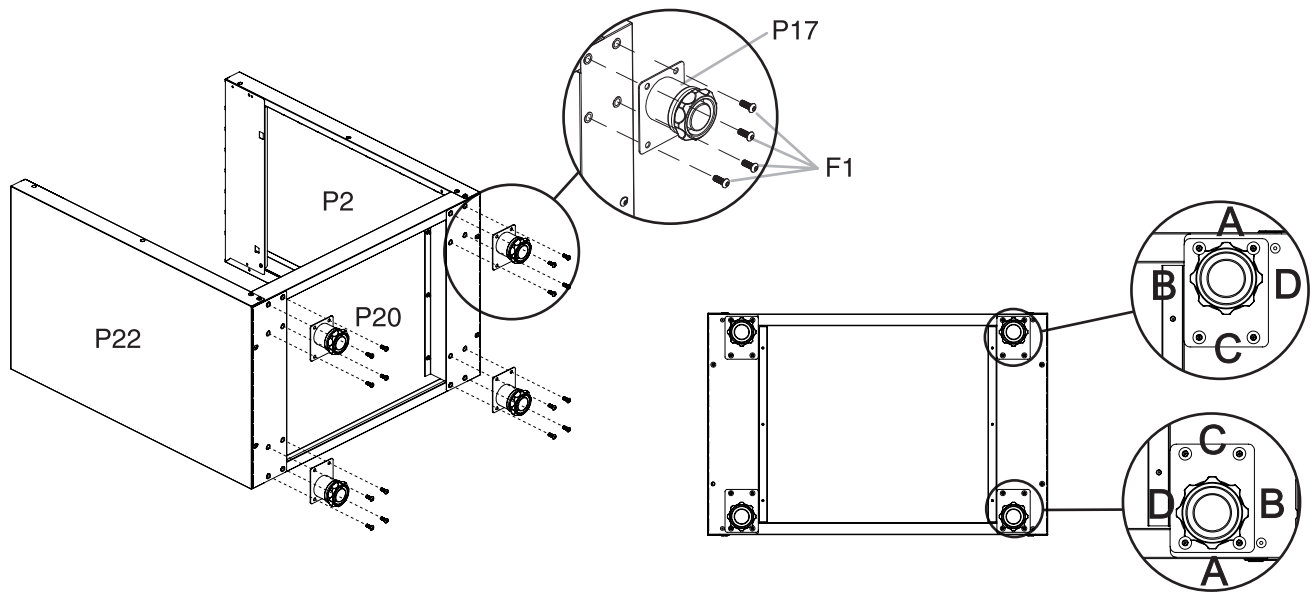

- Attach the adjustable feet (P17) to the bottom panel (P20). Make sure side A of the adjustable feet are facing towards the outside of the cabinet. Tighten securely with sixteen M6 x 16 hex socket head screws (F1).

4. Attach the back top beam and back panels

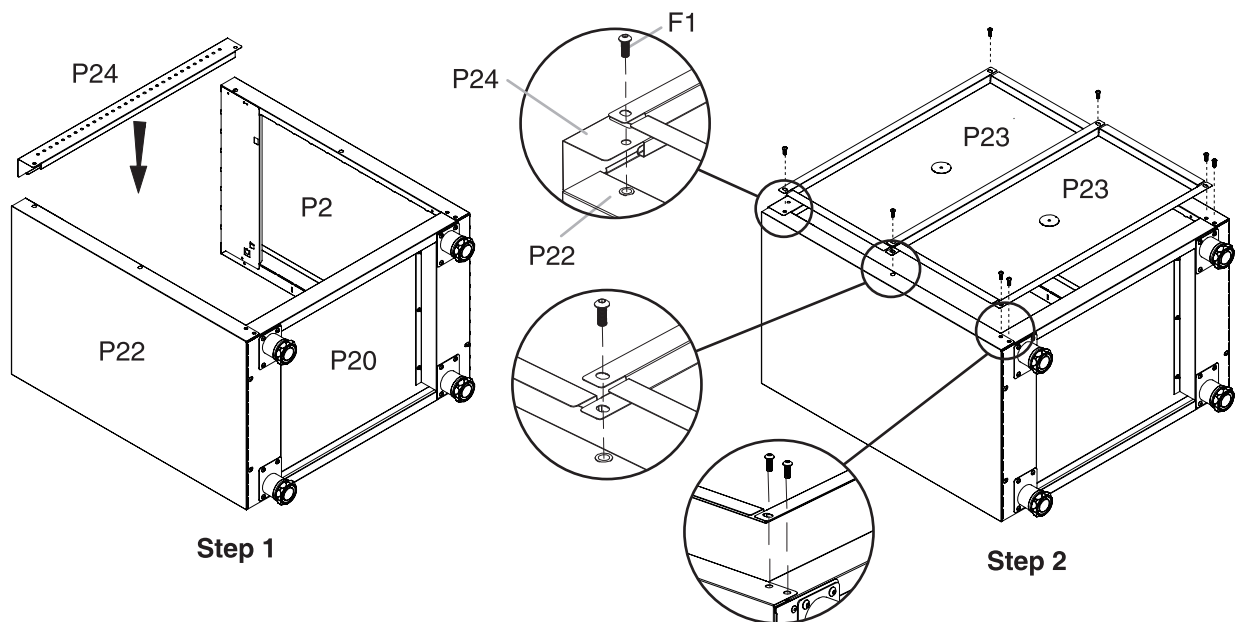

- Place the back top beam (P24) onto the side panels' top.
- Attach the back panels (P23) to the back of the cabinet with six M6 x 16 hex socket head screws (F1). Insert the screws by hand. DO NOT tighten.
- Connect the side panels and bottom panel together with two M6 x 16 hex socket head screws (F1). Insert the screws by hand. DO NOT tighten.

5. Attach the front top beam and the front center beam

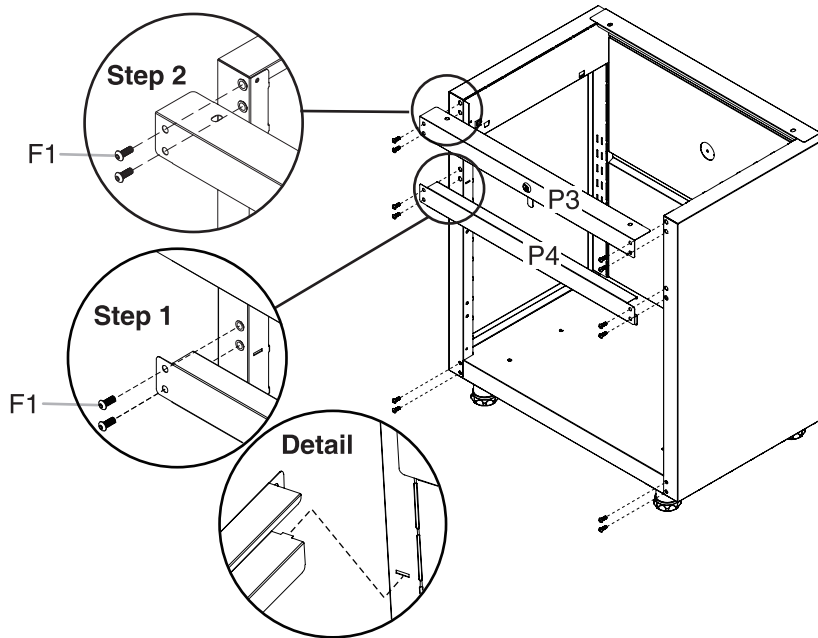

- Attach the center front beam (P4) to the side panels with four M6 x 16 hex socket head screws (F1). Insert the screws by hand. DO NOT tighten.
- Repeat to install the front top beam (P3)
- Connect the side panels and bottom panel together with four M6 x 16 hex socket head screws (F1). Insert the screws by hand. DO NOT tighten.

6. Install the slides

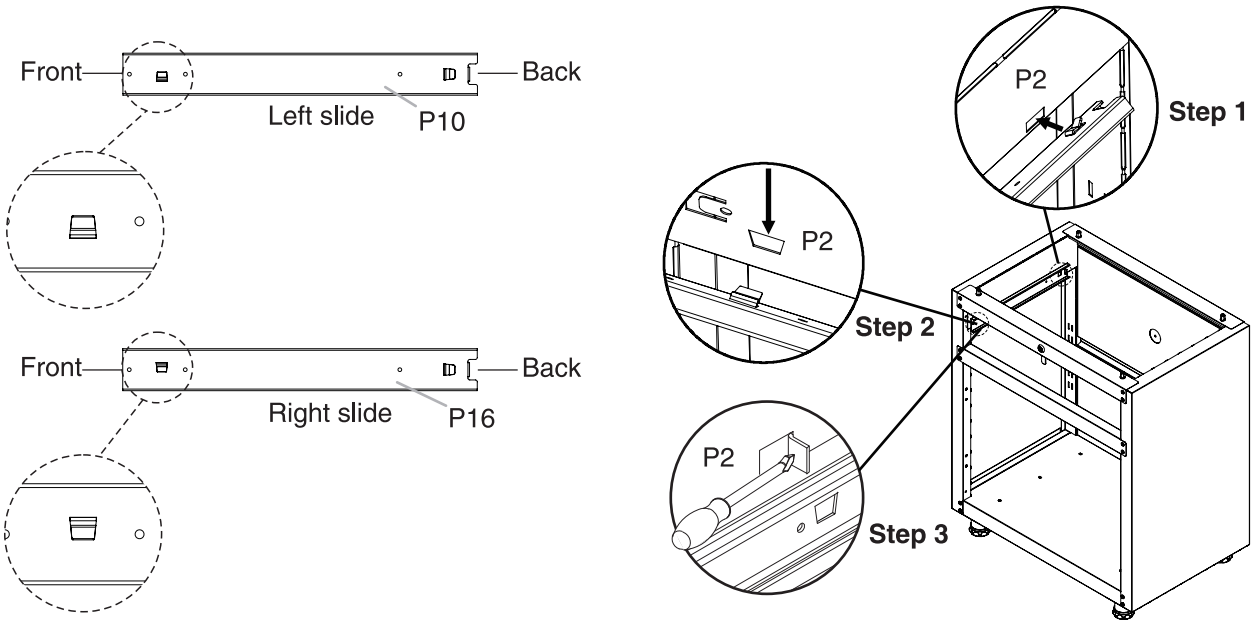

- Slide the back clip of the outer rail of the left slide (P10) into the back slot at the left side panel and slide the front clip of the outer rail into the slot at the front of the left side panel (P2).
- Repeat the same procedure to install the right slide to the right panel (P22).
- Bend the two clips at the side panels above the left and right slides outwards with the help of a straight screwdriver so as to secure the slides.

7. Attach the solid wood top

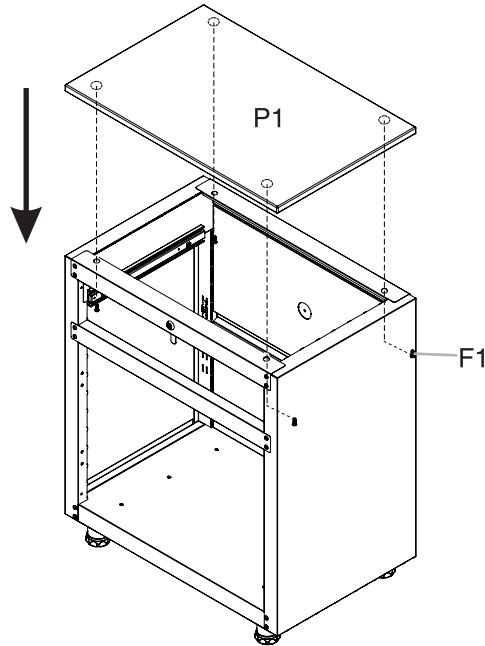

- Attach the wood top (P1) to the cabinet top by inserting four M6 x 16 hex socket head screws (F1) through the pre-drilled holes at the top beams to the wood top. Tighten securely.

8. Attach the doors

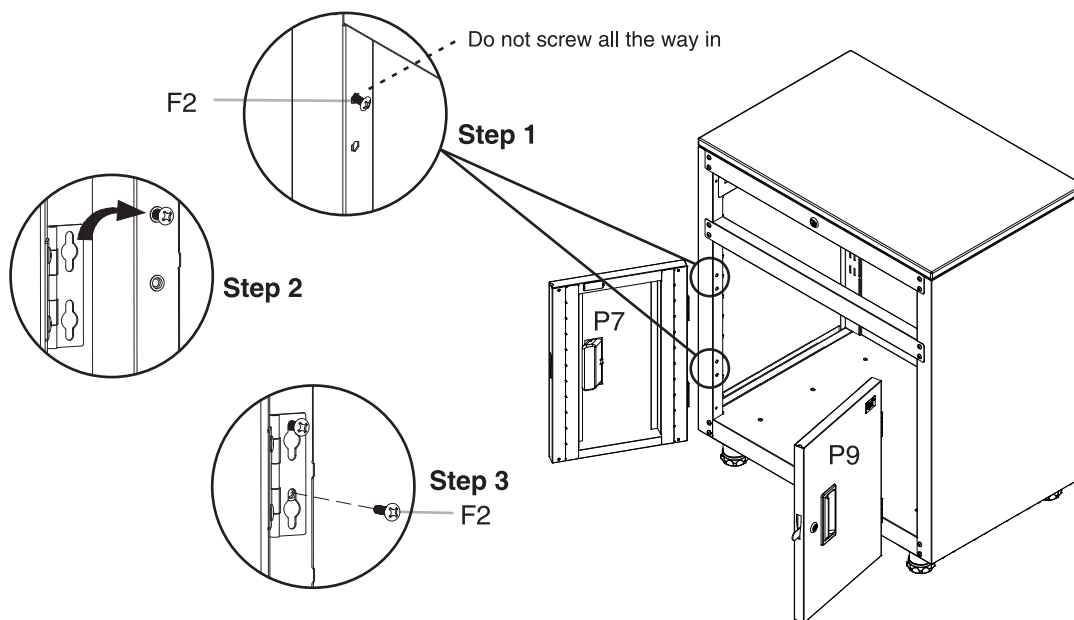

- Screw two M4 x 12 cross-shaped flat head screws (F1) on the inner side of the left side panel (P2), respectively to the top holes of the two hinge locations (circled areas on the drawing). DO NOT screw all the way in.
- Attach the left door (P7) to the left side panel by hanging the gourd holes of the two door hinges onto the two screws SIMULTANEOUSLY.
- Secure the left door (P7) with another two M4 x 12 cross-shaped flat head screws (F2). Tighten all screws securely.
- Repeat the same procedure to attach the right door (P9).

9. Adjust the cabinet and tighten the screws

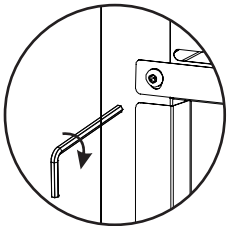

Back

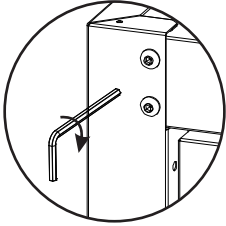

Front

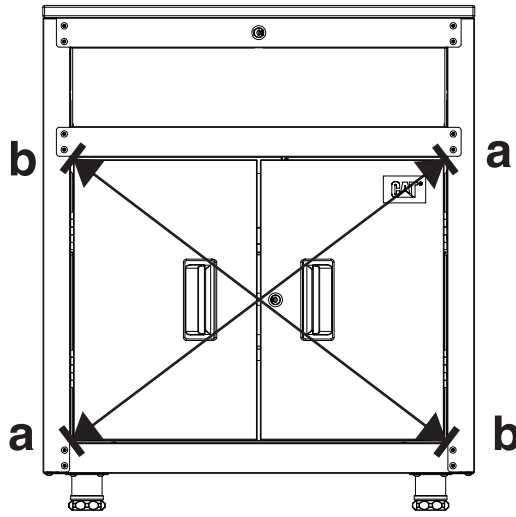

- Close the doors to see if they can touch the magnets completely and are flush with each other. If not, adjust the cabinet's top and side panels to make sure the shape of the cabinet is square and flush (diagonal line $aa=bb$).
- When the doors catch the magnets completely and are flush, tighten all the screws at the cabinet front and back.

10. Connect the cabinet to the wall

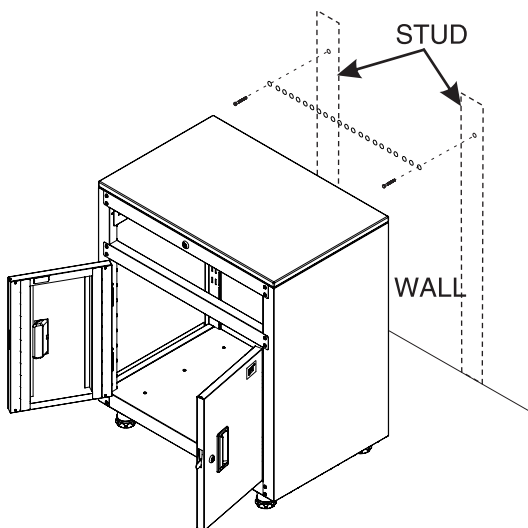

WARNING: The M6 x 40 hex tapping bolts (F4) should be drilled into the wall studs.

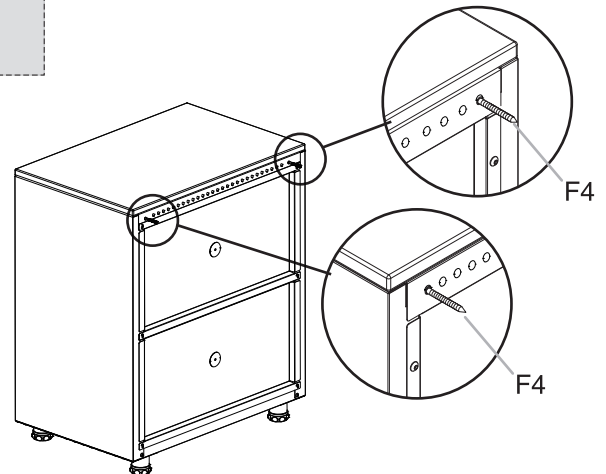

- Open the doors and fasten the cabinet to the wall with two M6 x 40 hex tapping bolts (F4).

11. Assemble the drawer

Step 1

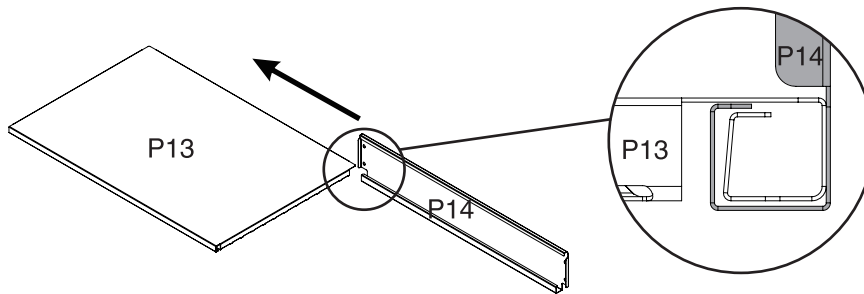

Step 2

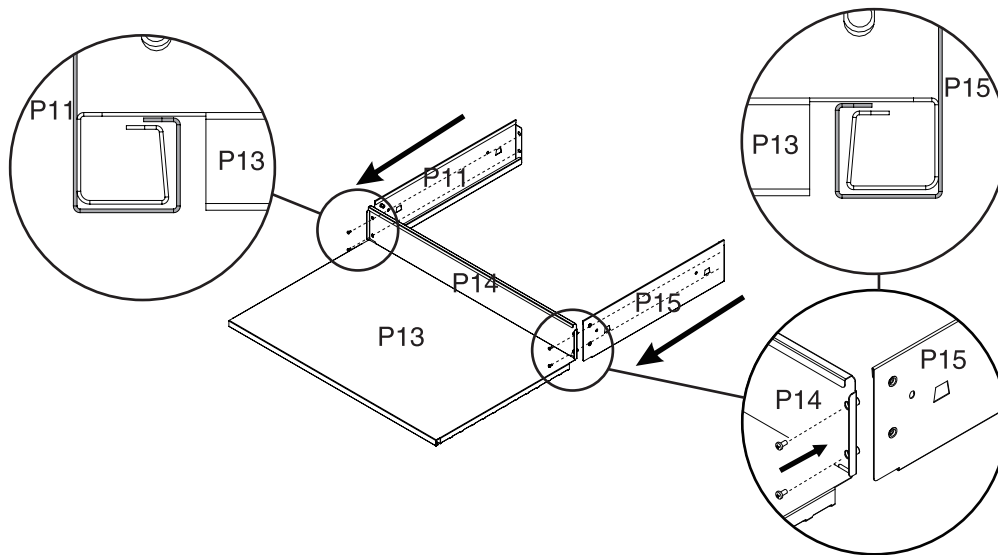

Step 3

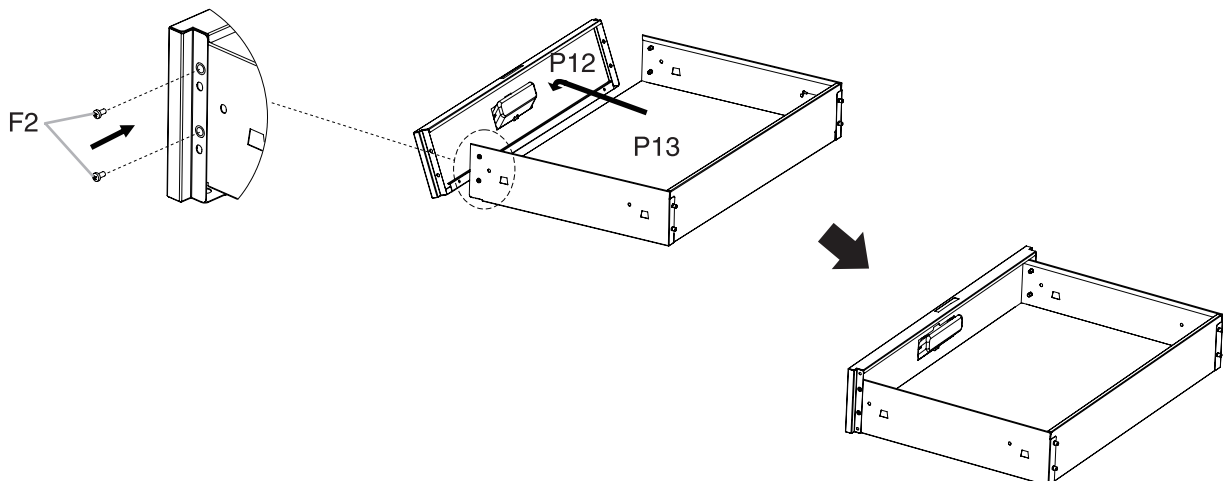

- Slide the bottom edge of the drawer back panel (P4) into the drawer bottom panel's (P13) bottom edge.
- Repeat the same procedure to attach the drawer's side panels (P11 & P13) to the drawer bottom panel.
- Attach the drawer body to the drawer front panel (P12) by putting the front bottom edge of the drawer body onto the bottom groove of the drawer front panel (P12).
- Connect all the panels together with eight M4 x 12 cross-shaped flat head screws (F2) as shown. Tighten securely.

12. Attach the drawer

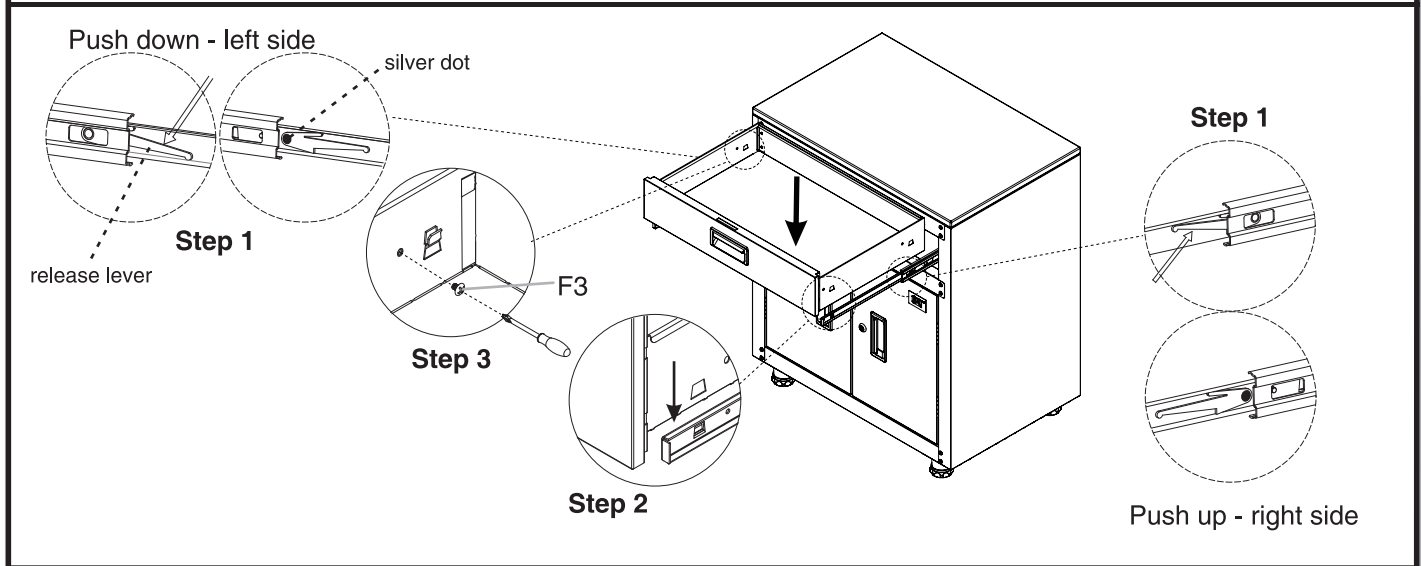

- Fully extend the drawer slides. There are two black release levers on each side of the inner rails.
- Push down the black release lever of the left inner rail and pull the inner rail outwards slightly until you see a silver dot.
- Push up the black release lever of the right inner rail and pull the inner rail outwards slightly until you see a silver dot.
- Attach the drawer to the inner rails by sliding the slots at the drawer's side panels onto the upright clips of the inner rails. Secure the drawer to the slides by screwing four M4 x 5 Phillips head bolts through the drawer to the slides. Place the drawer liner into the drawer.
- Push the drawer back into the cabinet to set the drawer in place.

13. Install the shelf

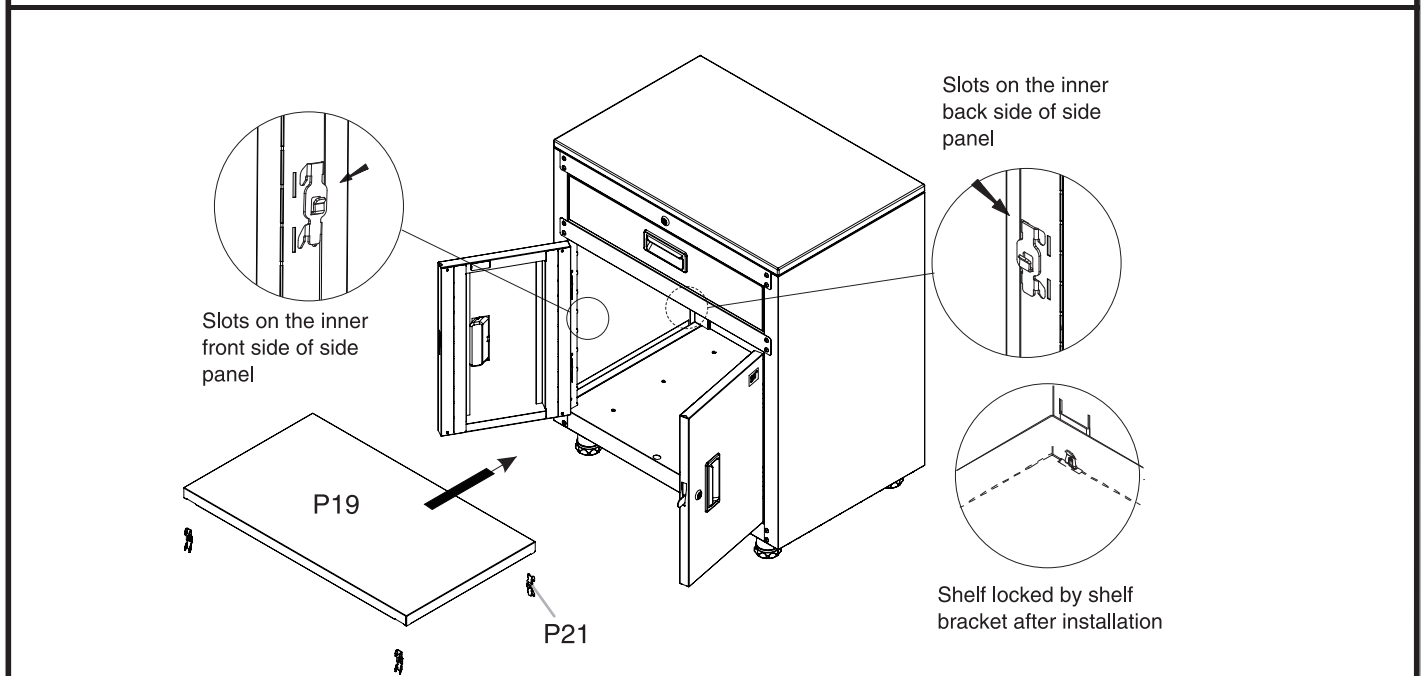

- Insert four shelf brackets (P21) into the slots on the side panels at the desired height. Make sure the four brackets are at the same height.
- Place the shelf (P19) over the shelf brackets, and push it down onto the shelf brackets. Make sure the shelf is properly and safely locked by the upright hooks of the shelf brackets.

DRAWER REPLACEMENT

Drawer removal

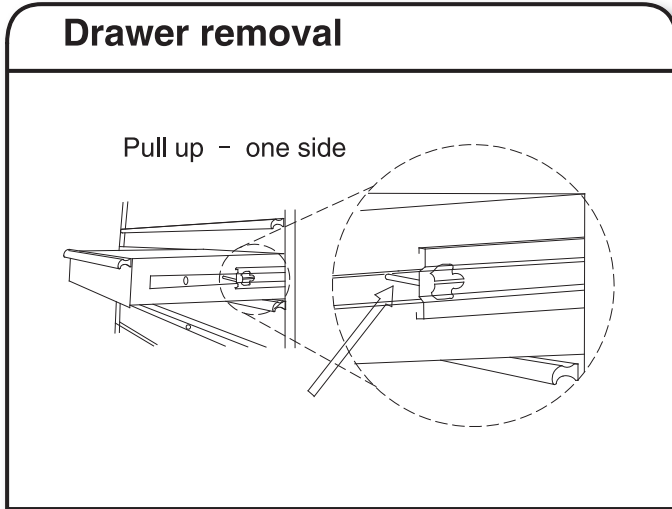

Empty the drawer. Pull the drawer out until almost fully extended. There are two black release levers, one on each side of the drawer. Pull up the black release lever on one side, while pushing down the black release lever on the other side. While holding the levers in the positions as instructed above, pull the drawer outward until it is released from the drawer slides.

Drawer installation

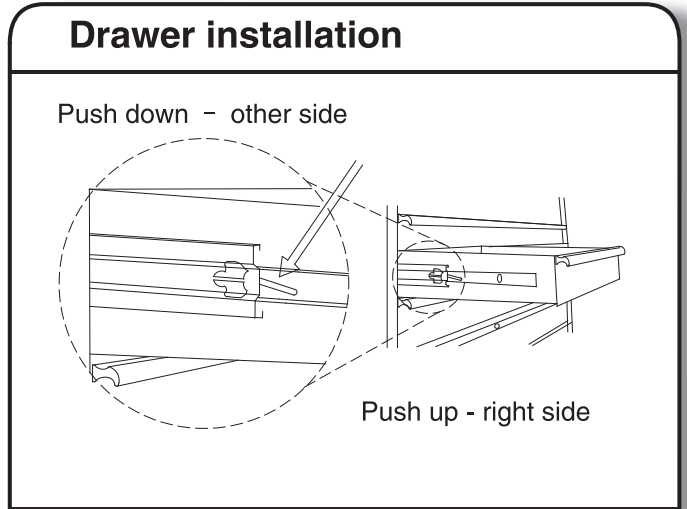

Extend the drawer slides from the tool chest or cabinet. Insert the brackets on each side of the drawer into the slots in the slides, being careful that they are properly positioned. Once properly inserted, completely close the drawer to set the slides in their proper positions.

MAINTENANCE

Check all the screws and nuts periodically for tightness. Tighten them when necessary.

CARE AND CLEANING

Periodically clean the surfaces with a soft rag and water.

Grease and oil can be removed with most standard cleaning fluids. For safety, use a nonflammable cleaning fluid.



Model:
CAT-GC2802B

28 IN. 2-DOOR BASE CABINET

Instruction Manual

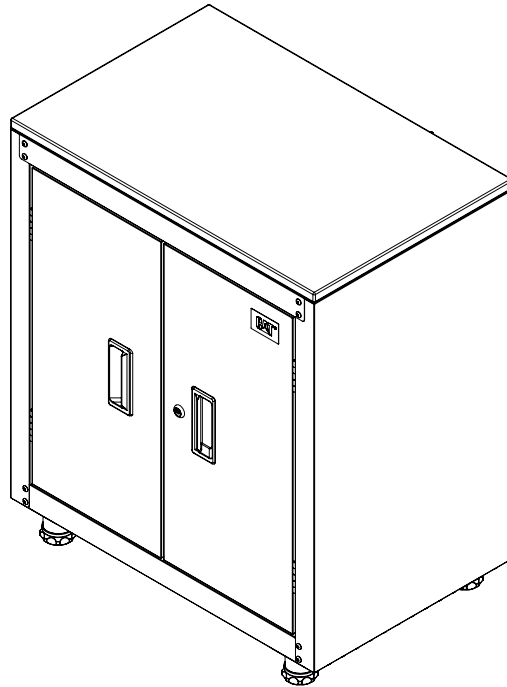

TABLE OF CONTENTS

CABINET SAFETY.....	2	ASSEMBLY INSTRUCTIONS.....	5
DIMENSIONS	3	MAINTENANCE	10
LOAD CAPACITY	3	CARE AND CLEANING.....	10
PARTS.....	4	WARRANTY.....	11
TOOLS REQUIRED FOR ASSEMBLY.....	5		

CABINET SAFETY

Your safety and the safety of others are very important.

We have provided many important safety messages in this manual and on your appliance. Always read and obey all safety messages.



This is the safety alert symbol.

This symbol alerts you to potential hazards that can kill or hurt you and others.

All safety messages will follow the safety alert symbol and either the word “DANGER” or “WARNING.” These words mean:

 **DANGER**

You can be killed or seriously injured if you don't immediately follow instructions.

 **WARNING**

You can be killed or seriously injured if you don't follow instructions.

All safety messages will tell you what the potential hazard is, tell you how to reduce the chance of injury, and tell you what can happen if the instructions are not followed.

To reduce the risk of serious injury, read and follow the safety instructions below before assembling and using this product.

- This product is intended for indoor use only.
- This product is not designed for commercial nor industrial usage.
- Solid wood refers to rubber wood.



WARNING: Use at least two people to move, assemble or install this product. Failure to do so can result in personal injury or product damage. Any assembly or maintenance of the product must be carried out by adults only.



WARNING: Close and lock the doors before moving this product.



WARNING: DO NOT alter this product in any manner. For example, do not weld external bar locks or attach electrical equipment. This may cause product damage or personal injury.



WARNING: Check all nuts and bolts periodically for tightness. When required, tighten them.



WARNING: DO NOT leave children unattended near this product. Cabinet may tip over if improperly opened.



WARNING: Keep the product on level surfaces. The product could become unstable and it may tip over if stored or moved on an uneven surface, which may cause personal injury, death or product damage.



WARNING: Do not sit or stand on or allow children to climb, sit or stand on the assembled product.



WARNING: Do not use without installing the tip restraint.



WARNING: Do not exceed the recommended weight limits.



WARNING: Evenly distribute the weight on each level and always keep the heavier loads on the bottom.



WARNING: Before cutting, drilling or hammering into any wall or floor surface, verify the location of electrical, plumbing and gas lines. Cutting may cause serious injury.

DIMENSIONS

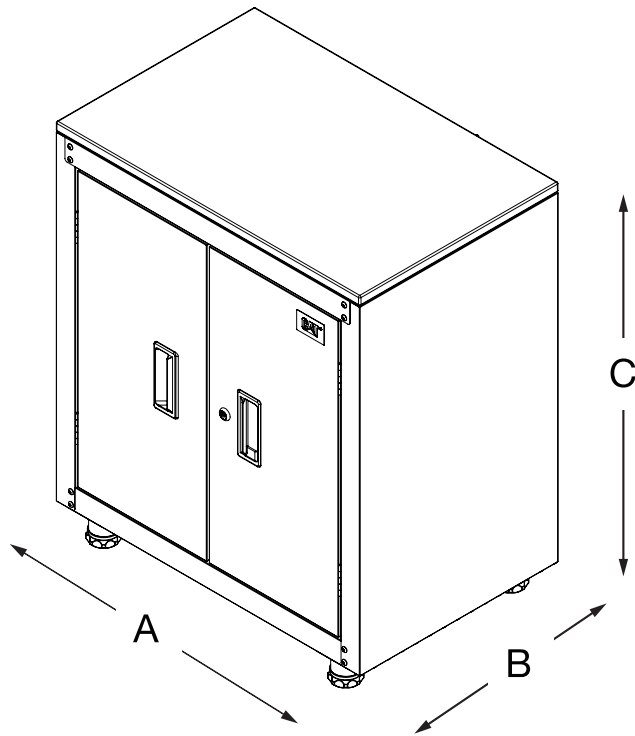

Model	CAT-GC2802B
A	28" (71.3 cm)
B	18.3" (46.6 cm)
C	32.8" (83.4 cm)

LOAD CAPACITY

Maximum load for shelf	100 lb / 45.4 kg
Maximum load for bottom panel	100 lb / 45.4 kg
Maximum load for wood top	100 lb / 45.4 kg
Maximum total load	300 lb / 136 kg

PARTS

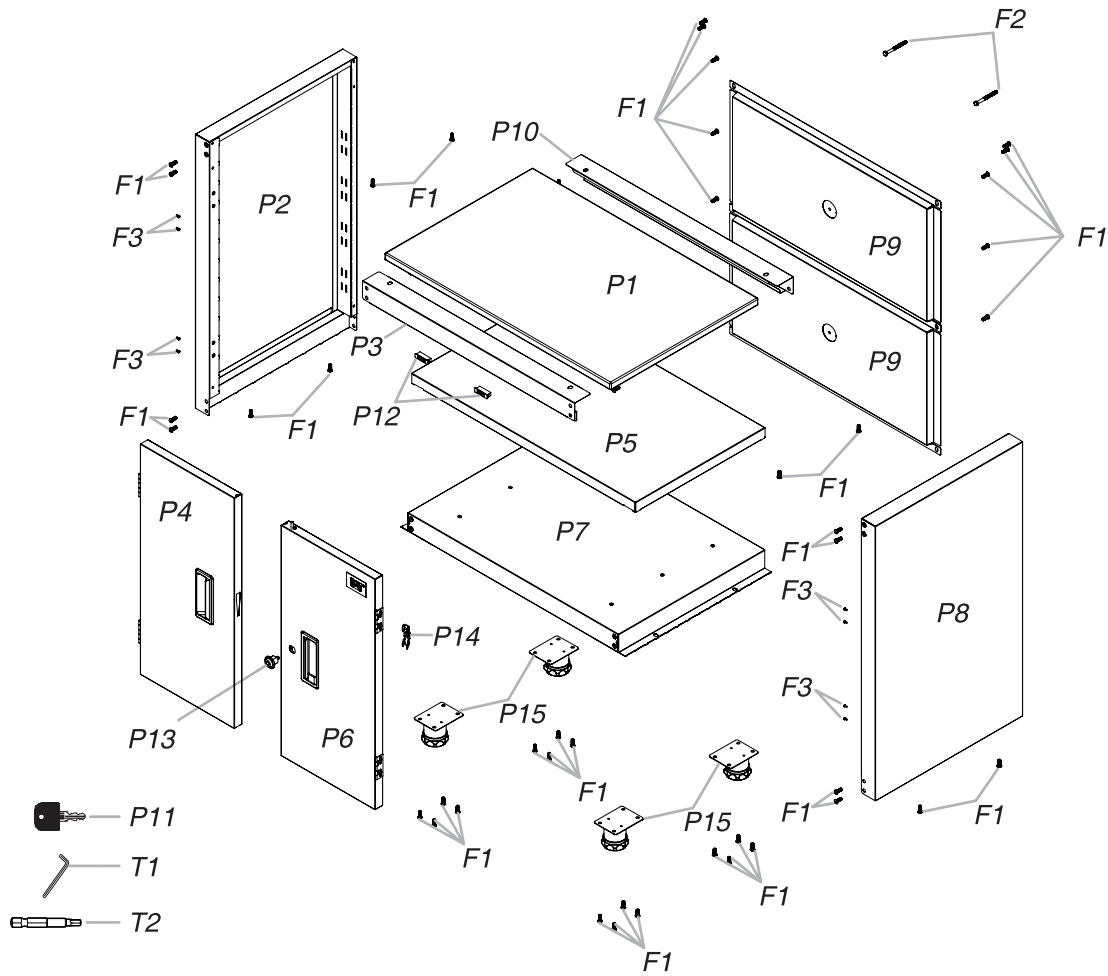

Ref#	Description	Part #	Qty
P1.	Solid wood top	307040	1
P2.	Left side panel	123851	1
P3.	Front top beam	124745	1
P4.	Left door	124348	1
P5.	Shelf	245787	1
P6.	Right door	124746	1
P7.	Bottom panel	123849	1
P8.	Right side panel	123852	1
P9.	Back panel	245788	2
P10.	Back top beam	245789	1
P11.	Key	304196	2

Ref#	Description	Part #	Qty
P12.	Magnet	312033	2
P13.	Lock	304279	1
P14.	Shelf bracket	243311	4
P15.	Adjustable foot	313066	4
T1.	Hex wrench (hex key)	317023	1
T2.	Hex screwdriver bit	317024	1
F1.	M6 x 16 hex socket head screw	320327	40
F2.	M6 x 40 hex tapping bolt	320328	2
F3.	M4 x 12 cross-shaped flat head screw	320084	8

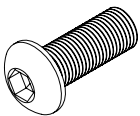

F1

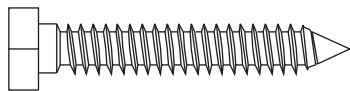

F2

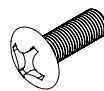

F3

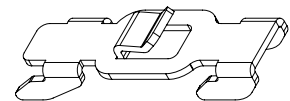

P14

TOOLS REQUIRED FOR ASSEMBLY

Gather the required tools and parts before starting installation.

Tools Needed

- Hex wrench (hex key) (T1)
- Hex screwdriver bit (Optional) (T2)
- Measuring tape (Not included)
- Power driver (Optional, not included)
- Gloves (Not included)

ASSEMBLY INSTRUCTIONS

1. Attach the side and bottom panels

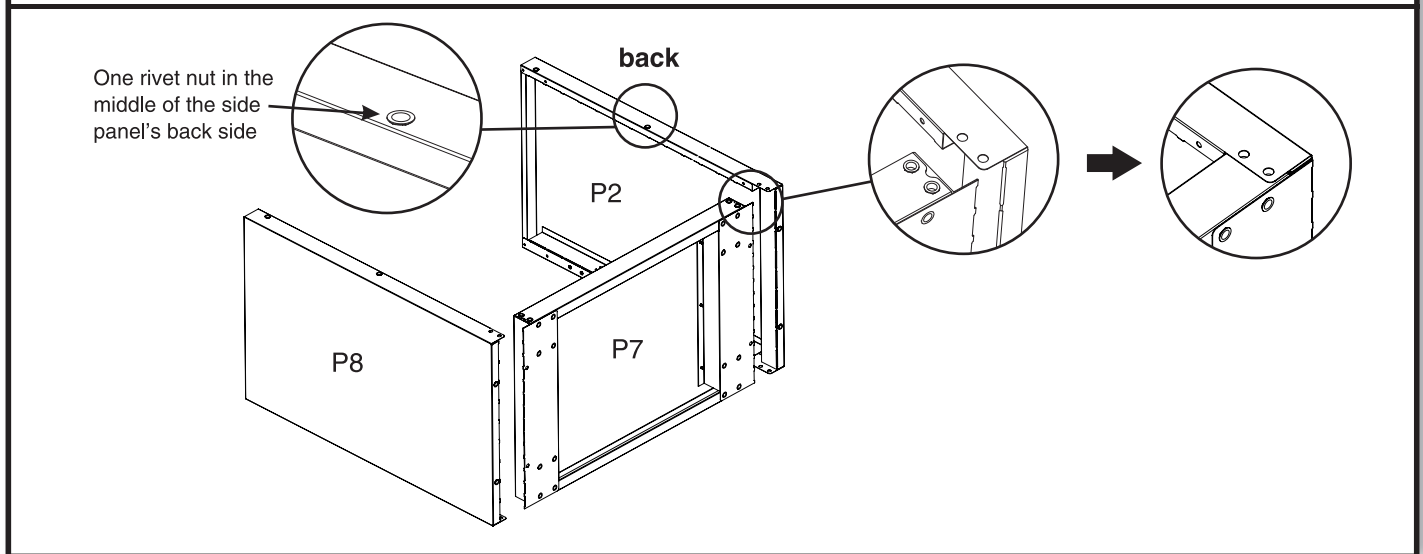

- Attach the side panels (P2 & P8) and bottom panel (P7) together.

2. Connect the side and bottom panels

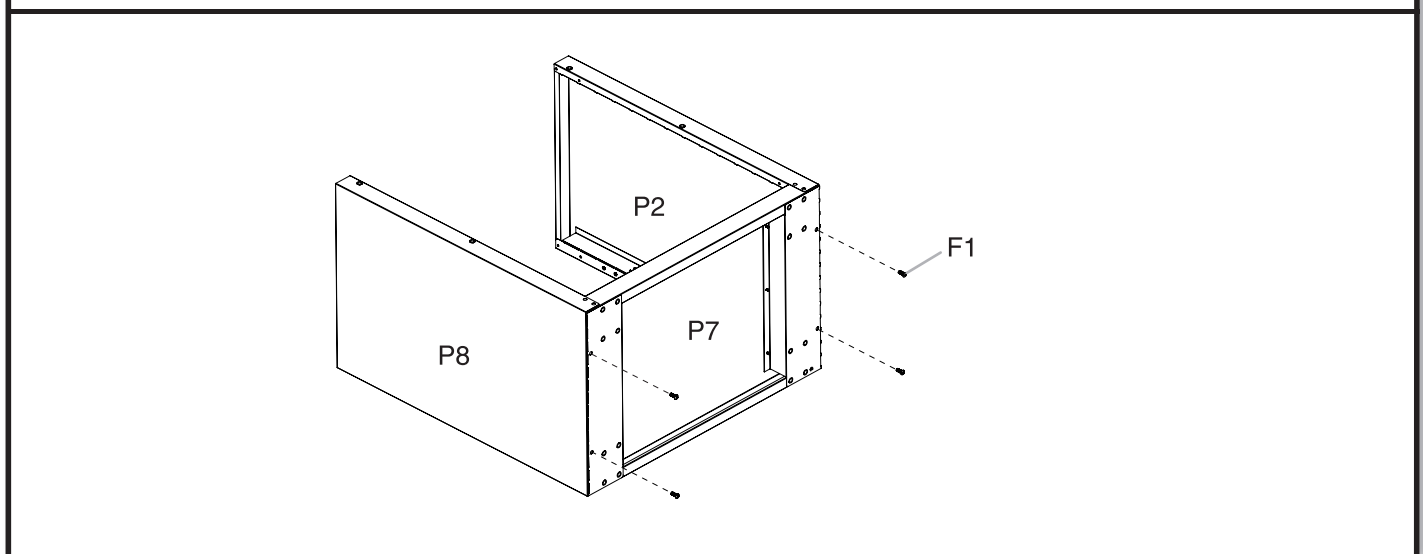

- Connect the side panels (P2 & P8) and the bottom panel (P7) with four M6 x 16 hex socket head screws (F1). Tighten securely.

3. Attach the adjustable feet

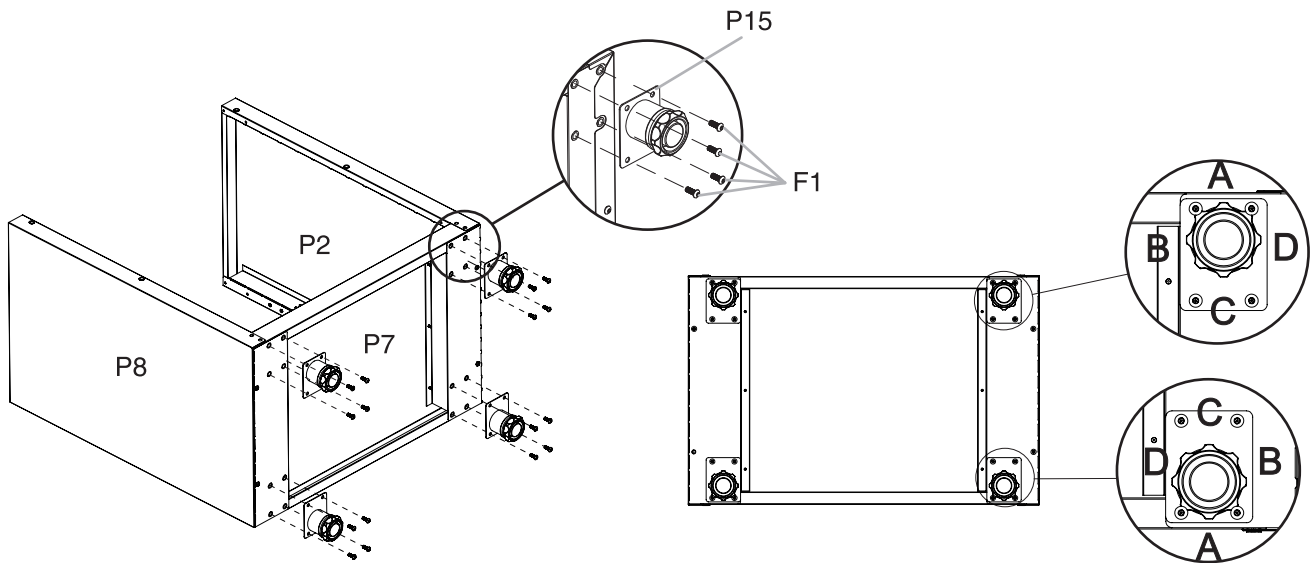

- Attach the adjustable feet (P15) to the bottom panel (P7). Make sure side A of the adjustable feet (P15) are facing towards the outside of the cabinet. Tighten securely with sixteen M6 x 16 hex socket head screws (F1).

4. Attach the back top beam and back panels

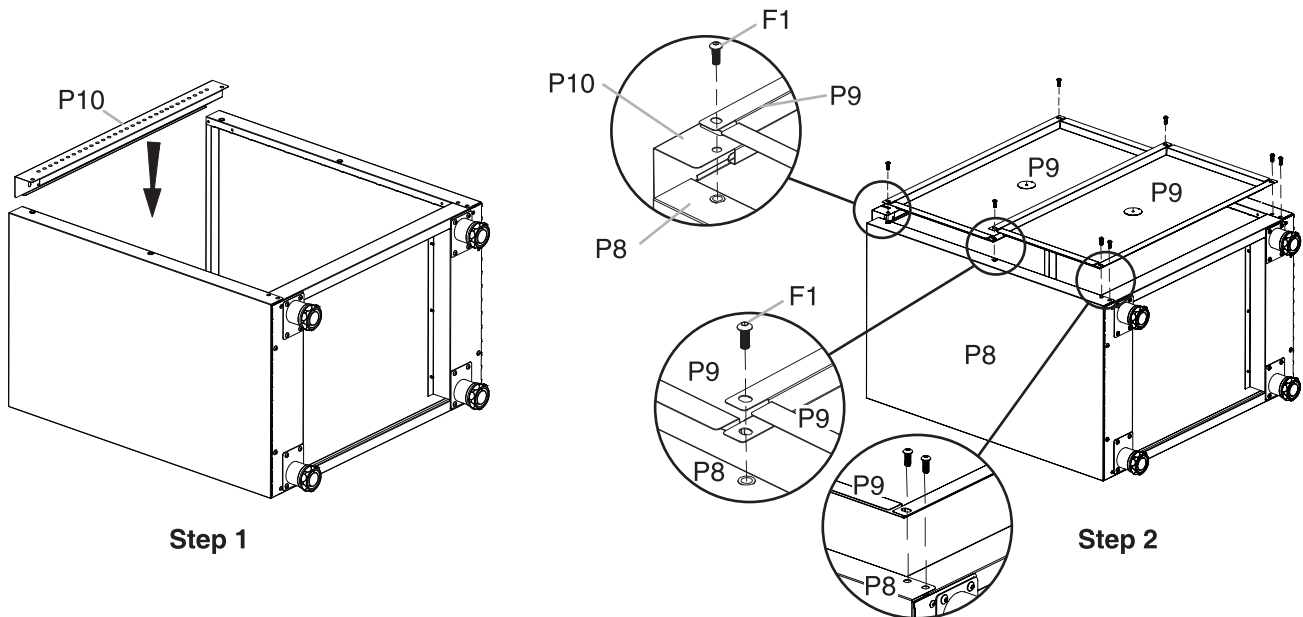

- Place the back top beam (P10) onto the side panels' top.
- Attach the back panels (P9) to the back of the cabinet with six M6 x 16 hex socket head screws (F1). Insert the screws by hand. DO NOT tighten.
- Connect the side panels and bottom panel together with two M6 x 16 hex socket head screws (F1). Insert the screws by hand. DO NOT tighten.

5. Attach the front top beam

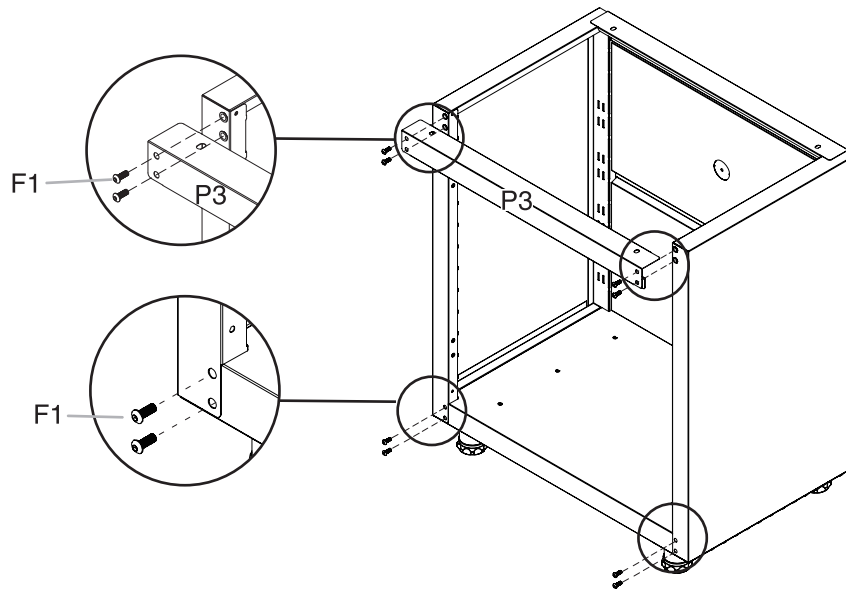

- Stand up the cabinet.
- Attach the front top beam (P3) to the side panels with four M6 x 16 hex socket head screws (F1). Insert the screws by hand. DO NOT tighten.
- Connect the side panels and bottom panel together with four M6 x 16 hex socket head screws (F1). Insert the screws by hand. DO NOT tighten.

6. Attach the solid wood top

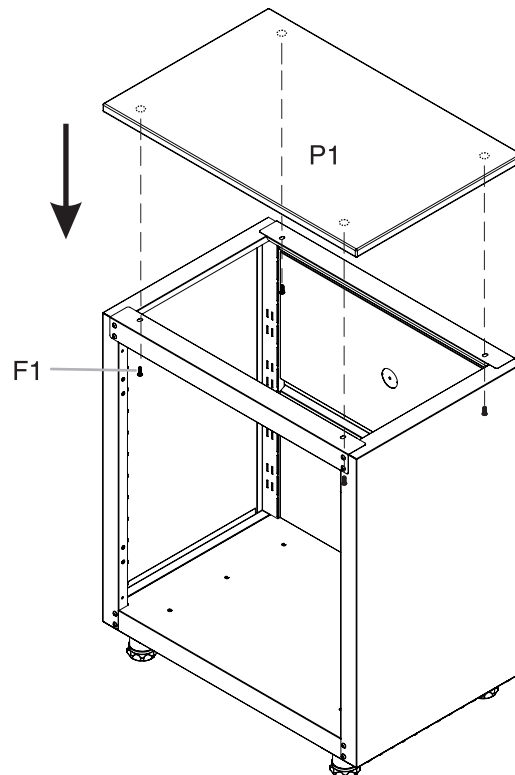

- Attach the wood top (P1) to the cabinet top by inserting four M6 x 16 hex socket head screws (F1) through the pre-drilled holes at the top beams to the wood top. Tighten securely.

7. Attach the doors

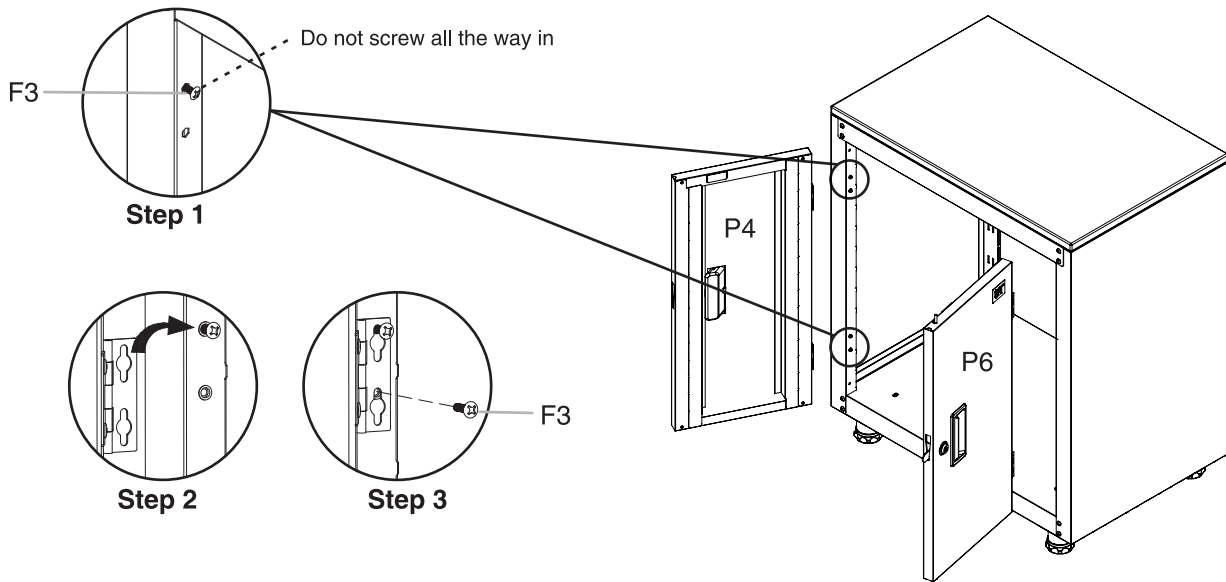

- Screw two M4 x 12 Cross-shaped flat head screws (F3) on the inner side panel, respectively to the top holes of the two hinge locations (circled areas on the drawing). DO NOT screw all the way in.
- Attach the left door (P4) to the left side panel by hanging the gourd holes of the two door hinges onto the two screws (F3) SIMULTANEOUSLY.
- Secure the left door (P4) with another two M4 x 12 Cross-shaped flat head screws (F3). Tighten all screws securely.
- Repeat the same procedure to attach the right door (P6).

8. Adjust the cabinet and tighten the screws

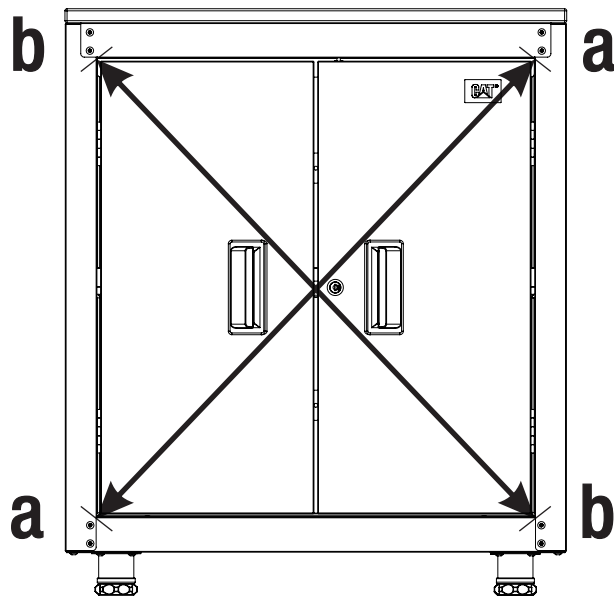
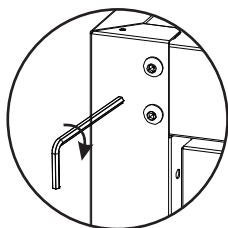
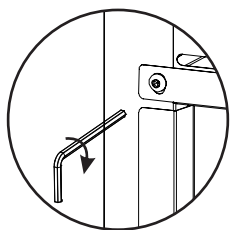

- Close the doors to see if they can touch the magnets completely and are flush with each other. If not, adjust the cabinet's top and side panels to make sure the shape of the cabinet is square and flush (diagonal lines $aa=bb$).
- When the doors catch the magnets completely and are flush, tighten all the screws at the cabinet front and back.

9. Connect the cabinet to the wall

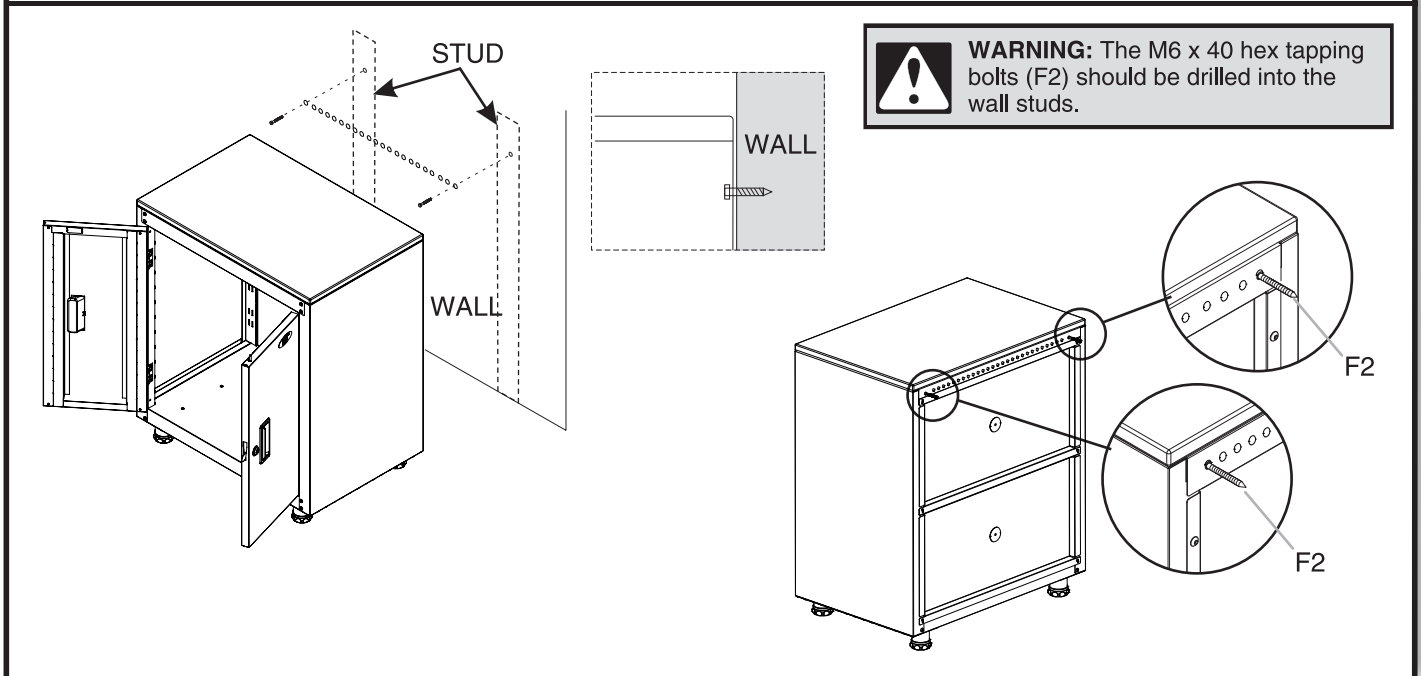

- Open the doors and fasten the cabinet to the wall with two M6 x 40 hex tapping bolts (F2).

10. Install the shelf

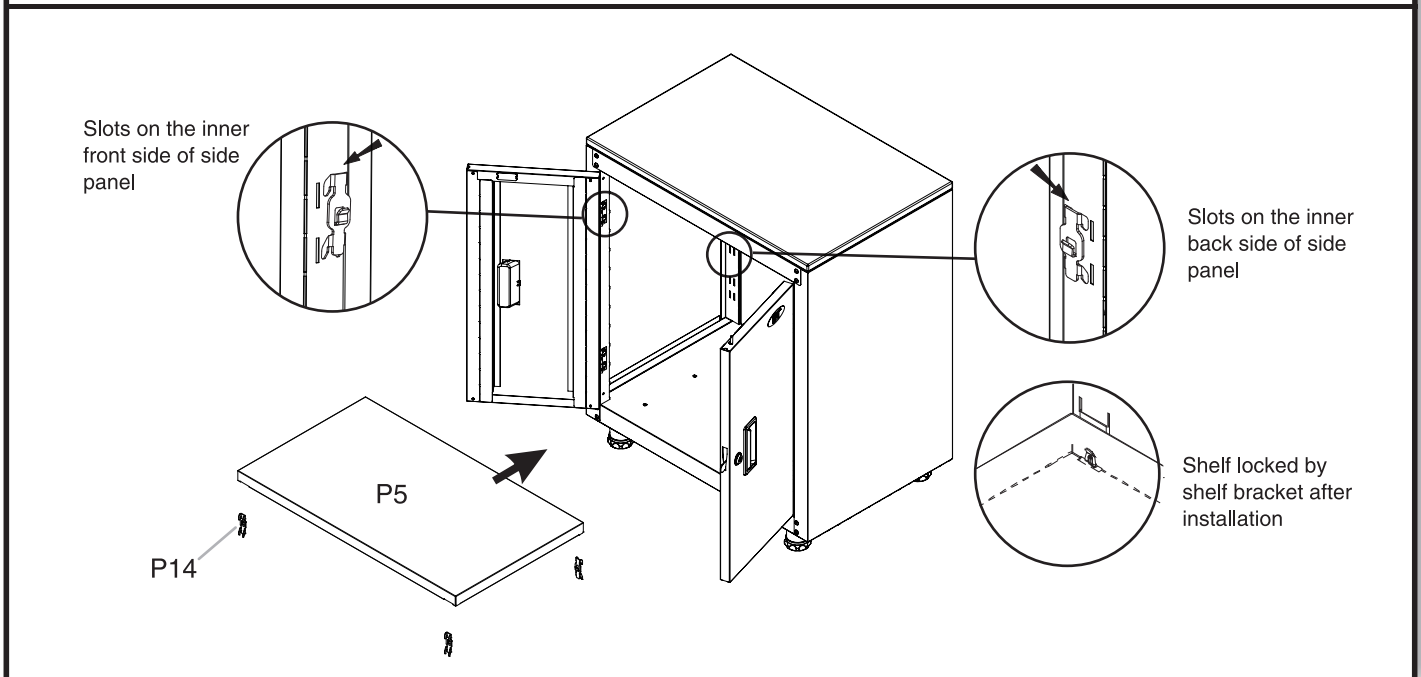

- Insert four shelf brackets (P14) into the slots on the side panels at the desired height. Make sure the four brackets (P14) are at the same height.
- Place the shelf (P5) over the shelf brackets (P14), and push it down onto the shelf brackets (P14). Make sure the shelf (P5) is properly and safely locked by the upright hooks of the shelf brackets (P14).

MAINTENANCE

Check all the screws and nuts periodically for tightness. Tighten them when necessary.

CARE AND CLEANING

Periodically clean the surfaces with a soft rag and water.

Grease and oil can be removed with most standard cleaning fluids. For safety, use a nonflammable cleaning fluid.



Model:
CAT-GC3602T

36 IN. TALL CABINET

Instruction Manual

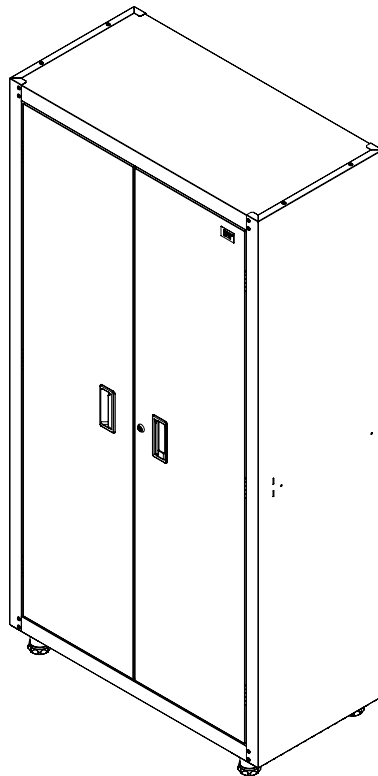

TABLE OF CONTENTS

CABINET SAFETY.....	2	ASSEMBLY INSTRUCTIONS.....	5
DIMENSIONS	3	MAINTENANCE.....	10
LOAD CAPACITY	3	CARE AND CLEANING.....	10
PARTS.....	4	WARRANTY.....	11
TOOLS REQUIRED FOR ASSEMBLY.....	5		

CABINET SAFETY

Your safety and the safety of others are very important.

We have provided many important safety messages in this manual and on your appliance. Always read and obey all safety messages.



This is the safety alert symbol.

This symbol alerts you to potential hazards that can kill or hurt you and others.

All safety messages will follow the safety alert symbol and either the word “DANGER” or “WARNING.” These words mean:

 **DANGER**

You can be killed or seriously injured if you don't immediately follow instructions.

 **WARNING**

You can be killed or seriously injured if you don't follow instructions.

All safety messages will tell you what the potential hazard is, tell you how to reduce the chance of injury, and tell you what can happen if the instructions are not followed.

To reduce the risk of serious injury, read and follow the safety instructions below before assembling and using this product.

- This product is intended for indoor use only.
- This product is not designed for commercial nor industrial usage.



WARNING: Use at least two people to move, assemble or install this product. Failure to do so can result in personal injury or product damage. Any assembly or maintenance of the product must be carried out by adults only.



WARNING: Close and lock the doors before moving this product.



WARNING: DO NOT alter this product in any manner. For example, do not weld external bar locks or attach electrical equipment. This may cause product damage or personal injury.



WARNING: Check all nuts and bolts periodically for tightness. When required, tighten them.



WARNING: DO NOT leave children unattended near this product. Cabinet may tip over if improperly opened.



WARNING: DO NOT allow children to climb, sit on the product.



WARNING: Keep the product on level surfaces. The product could become unstable and it may tip over if stored or moved on an uneven surface, which may cause personal injury, death or product damage.



WARNING: DO NOT stand on the product and do not use it as scaffold.



WARNING: It is always recommended to secure this product to the wall with the anti-tip hardware provided.



WARNING: DO NOT put anything on the top panel of this product.



WARNING: Do not exceed the recommended weight limits.



WARNING: Evenly distribute the weight on each level and always keep the heavier loads on the bottom.



WARNING: Before cutting, drilling or hammering into any wall or floor surface, verify the location of electrical, plumbing and gas lines. Cutting may cause serious injury.

DIMENSIONS

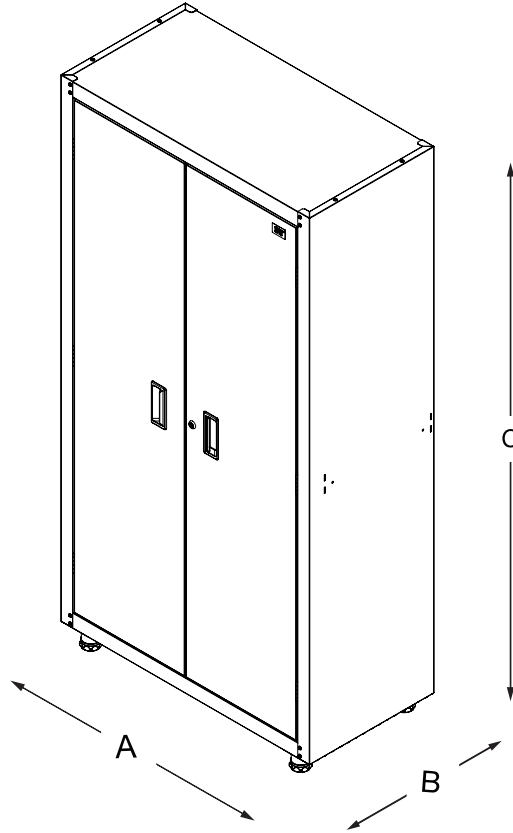

Model	CAT-GC3602T
A	36.6" (93 cm)
B	18.3" (46.6 cm)
C	72.2" (183.3 cm)

LOAD CAPACITY

Maximum load for each shelf	150 lb / 68 kg
Maximum load for bottom panel	150 lb / 68 kg
Maximum total load	600 lb / 272 kg

PARTS

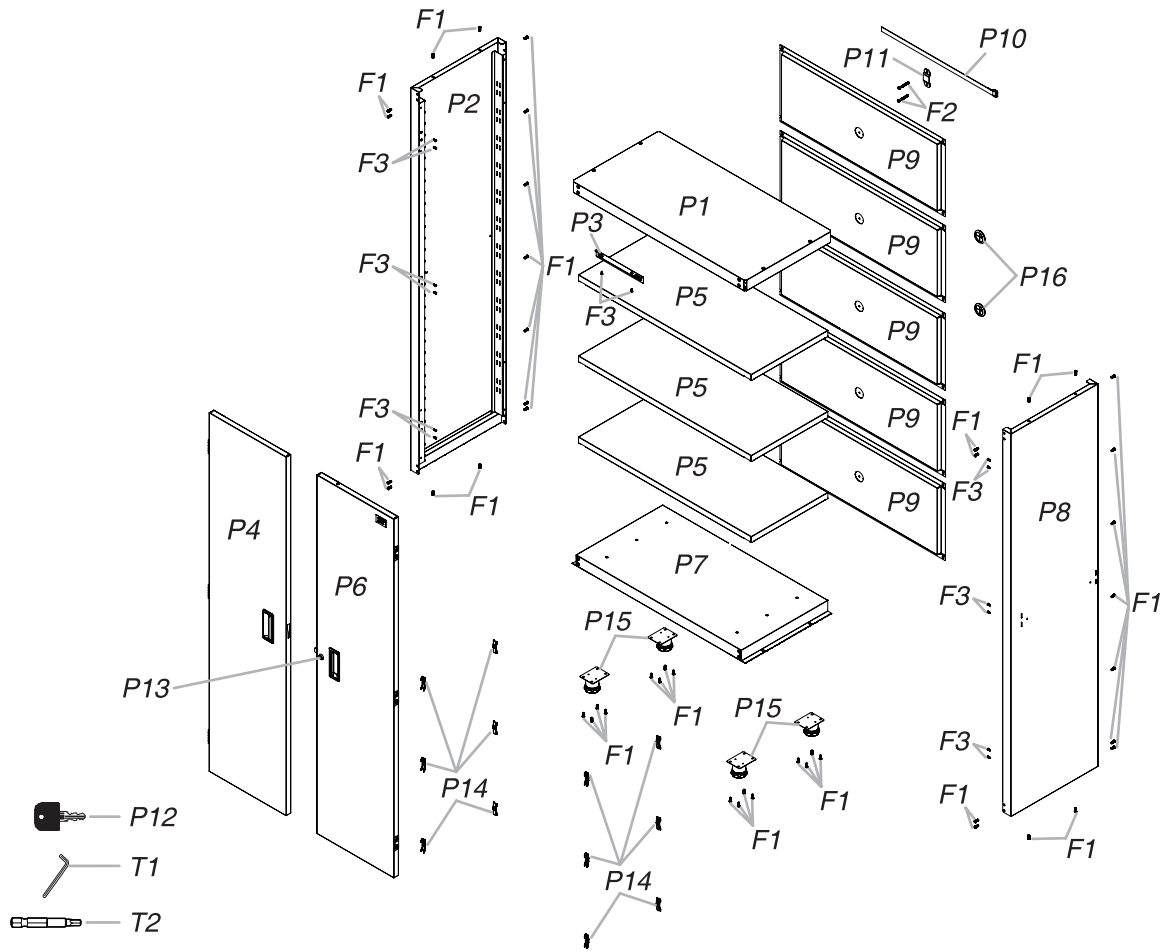

Ref#	Description	Part #	Qty
P1.	Top panel	123843	1
P2.	Left side panel	123841	1
P3.	Door stopper	124219	1
P4.	Left door	124364	1
P5.	Shelf	245770	3
P6.	Right door	124770	1
P7.	Bottom panel	123839	1
P8.	Right side panel	123842	1
P9.	Back panel	245772	5
P10.	Safety strap	314230	1
P11.	Safety bracket	212591	1

Ref#	Description	Part #	Qty
P12.	Key	304196	2
P13.	Lock	304279	1
P14.	Shelf bracket	243311	12
P15.	Adjustable foot	313066	4
P16.	Grommet	314295	2
T1.	Hex wrench (hex key)	317023	1
T2.	Hex screwdriver bit	317024	1
F1.	M6 x 16 hex socket head screw	320327	46
F2.	M6 x 40 hex tapping bolt	320328	2
F3.	M4 x 12 Cross-shaped flat head screw	320084	14

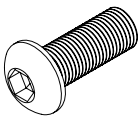

F1

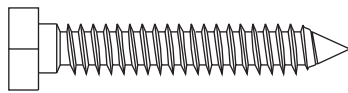

F2

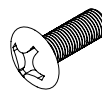

F3

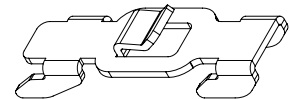

P14

TOOLS REQUIRED FOR ASSEMBLY

Gather the required tools and parts before starting installation.

Tools Needed

- Hex wrench (hex key) (T1)
- Hex screwdriver bit (Optional) (T2)
- Measuring tape (Not included)
- Power driver (Optional, not included)
- Gloves (Not included)

ASSEMBLY INSTRUCTIONS

1. Attach the side and bottom panels

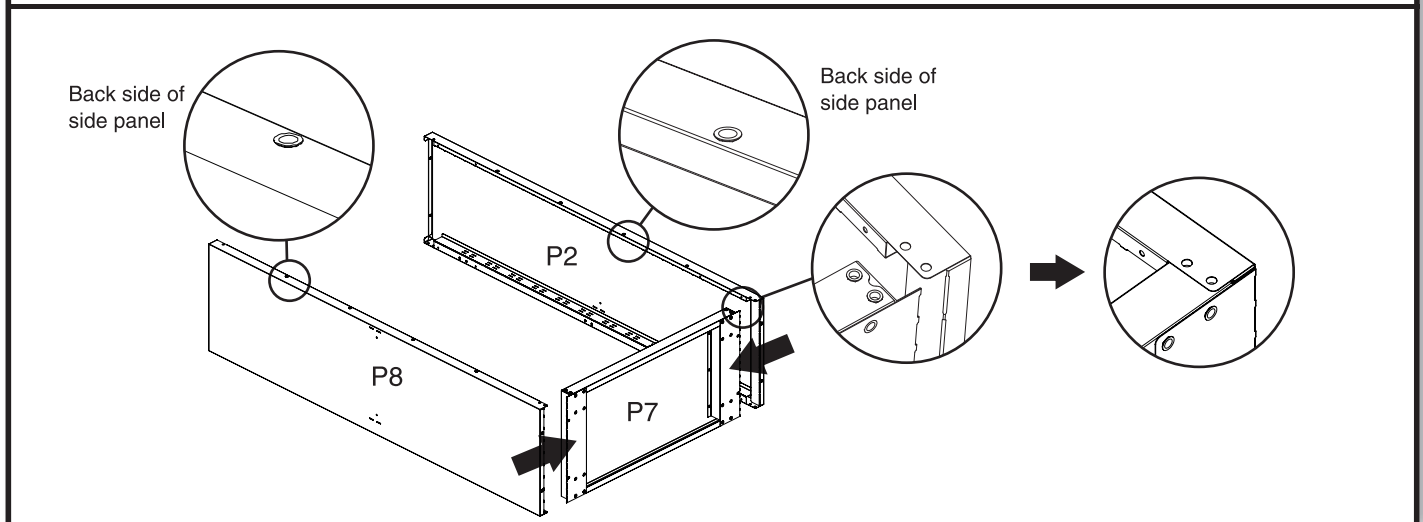

- Attach the side panels (P2 & P8) and bottom panel (P7) together.

2. Attach the adjustable feet

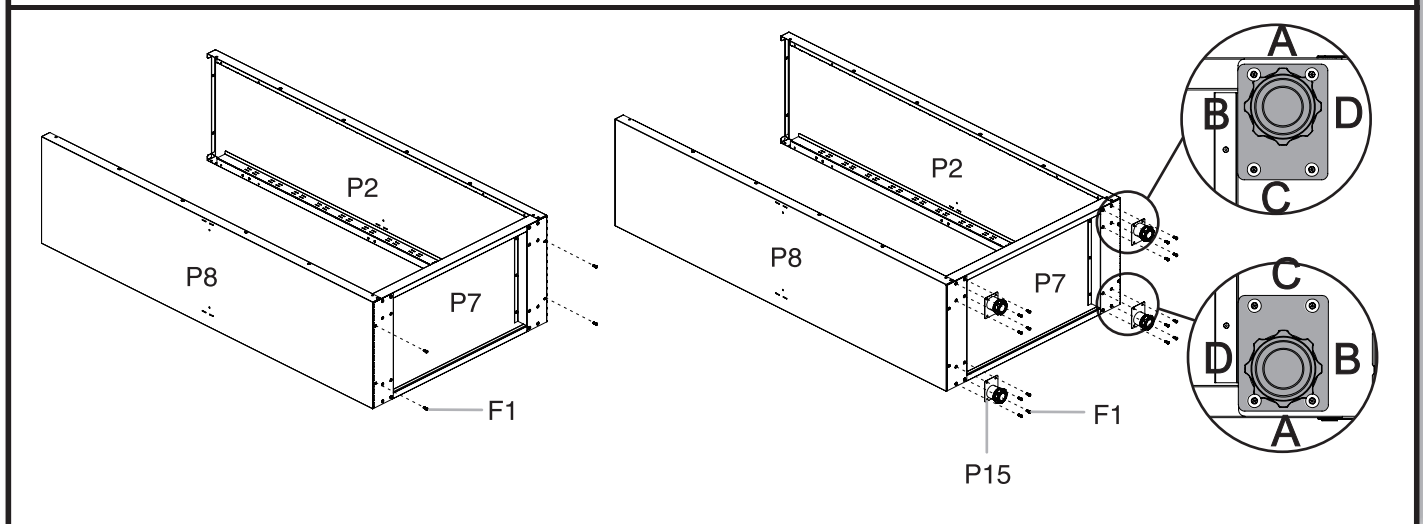

- Connect the side panels (P2 & P8) and the bottom panel (P7) with four M6 x 16 hex socket head screws (F1) at the bottom. Tighten securely.
- Attach the adjustable feet (P15) to the bottom panel (P7). Make sure side A of the adjustable feet (P15) are facing towards the outside of the cabinet. Tighten securely with sixteen M6 x 16 hex socket head screws (F1).

3. Attach the top panel

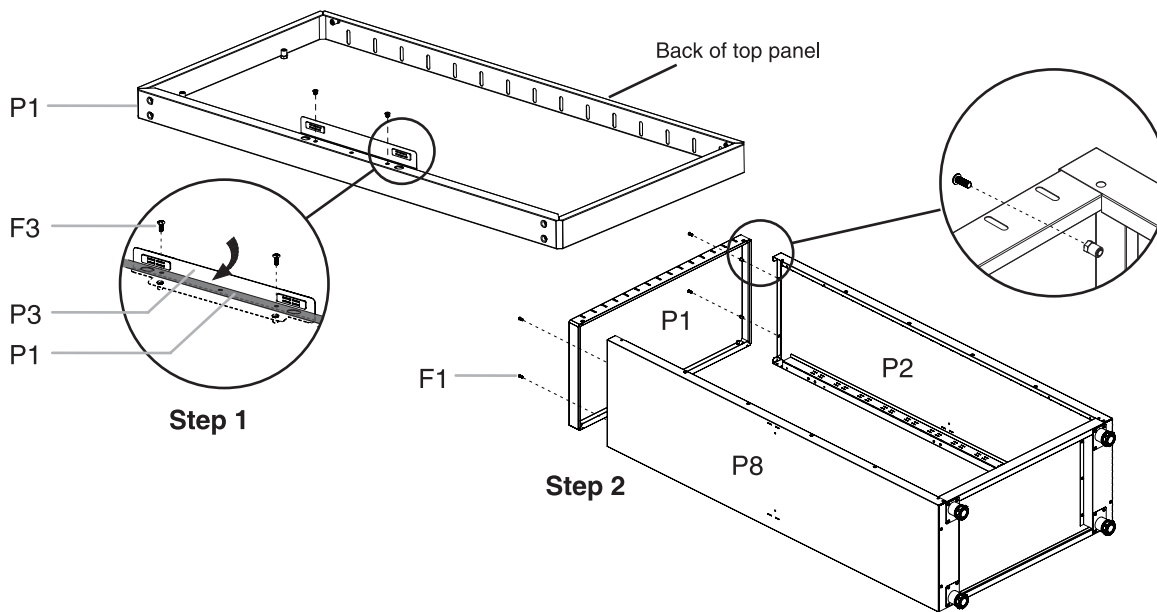

- Attach the door stopper (P3) to the top panel (P1) and fix with two M4 x 12 cross-shaped flat head screws (F3).
- Attach the top panel (P1) to the side panels (P2 & P8) with four M6 x 16 hex socket head screws (F1). Tighten securely.

4. Attach the back panels

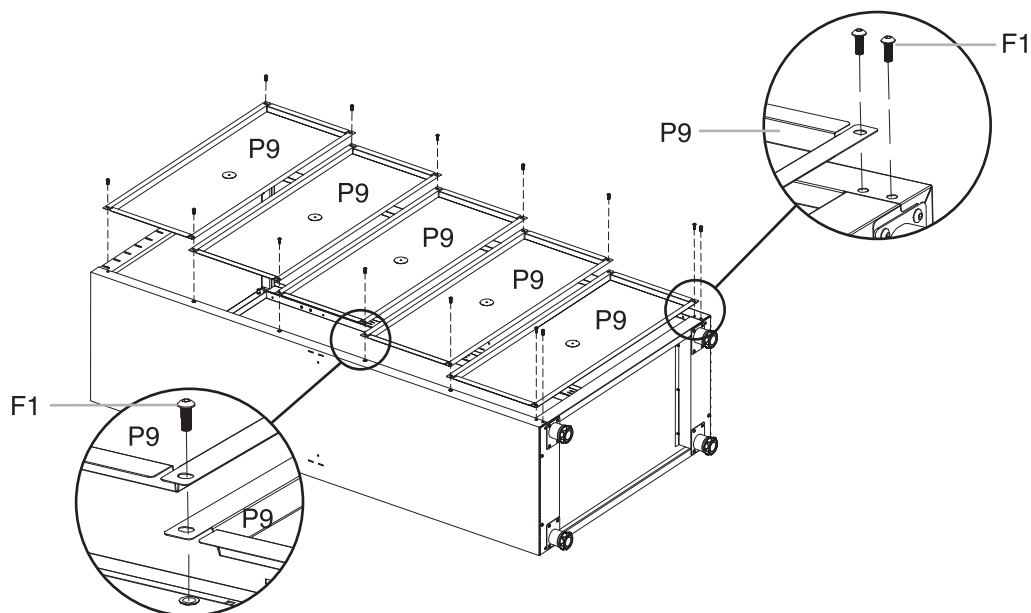

- Attach the back panels (P9) to the back of the cabinet with twelve M6 x 16 hex socket head screws (F1). Insert the screws by hand. DO NOT tighten.
- Fix the side panels and bottom panel together with two M6 x 16 hex socket head screws (F1). Insert the screws by hand. DO NOT tighten.

5. Connect the top, bottom and side panels

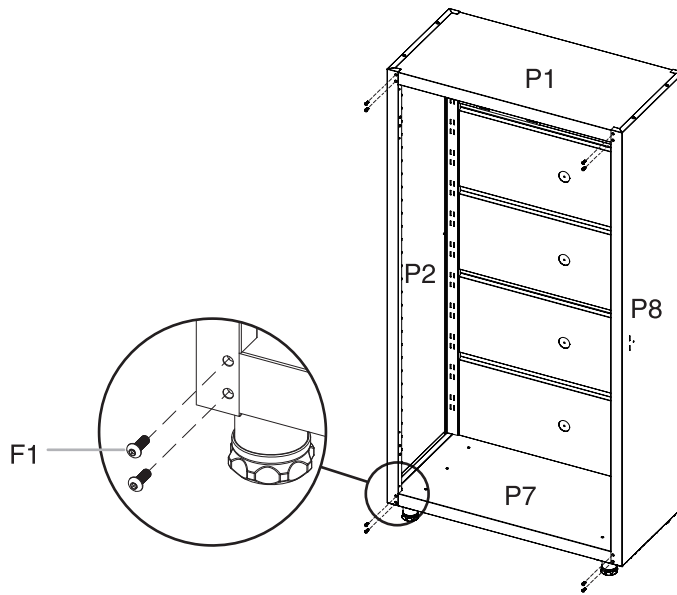

- Stand up the cabinet
- Connect the top panel (P1), bottom panel (P3) and side panels (P2 & P8) at the front with eight M6 x 16 hex socket head screws (F1). Insert the screws by hand. DO NOT tighten.

6. Attach the doors



NOTE: You may need one more person for assistance to complete this step.

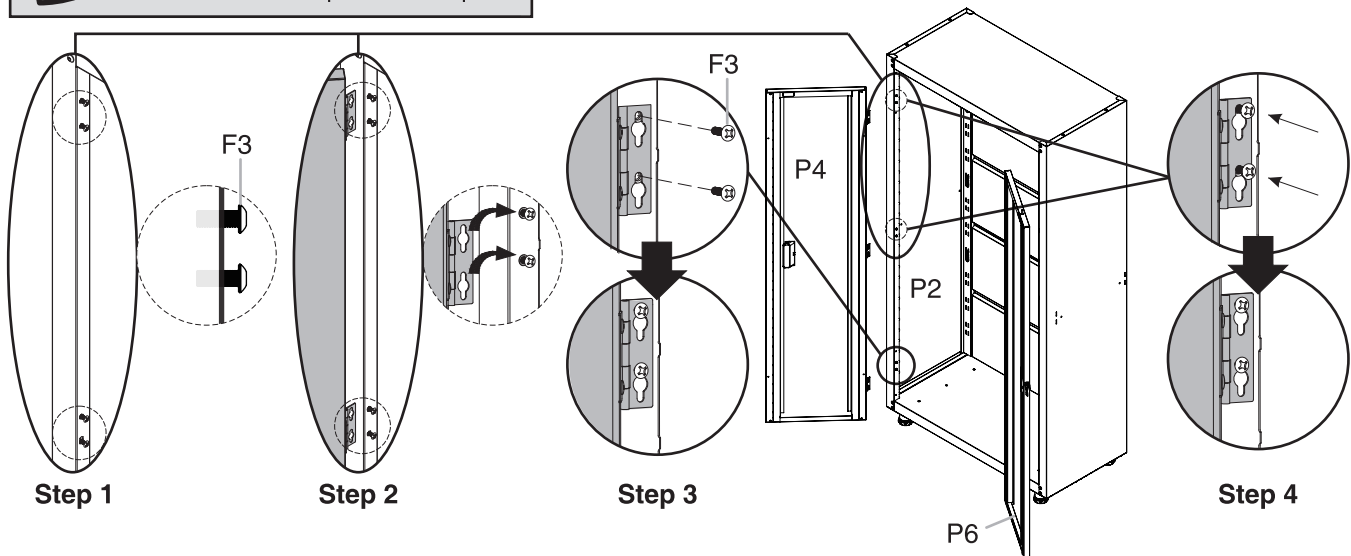

- Screw four M4 x 12 cross-shaped flat head screws (F3) on the inner side of the left side panel (P2). Two on top and two on the middle. DO NOT screw all the way in.
- Attach the left door (P4) to the left side panel (P2) by hanging the gourd holes of the top and middle door hinges onto the four screws (F3) SIMULTANEOUSLY.
- Secure the left door (P4) with another two M4 x 12 cross-shaped flat head screws (F3) through the bottom hinge. Tighten all six screws (F3) through the hinges securely.
- Repeat the same procedure to attach the right door (P6).

7. Adjust the cabinet and tighten the screws

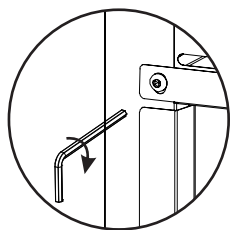

Back

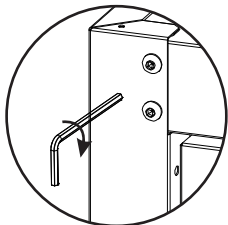

Front

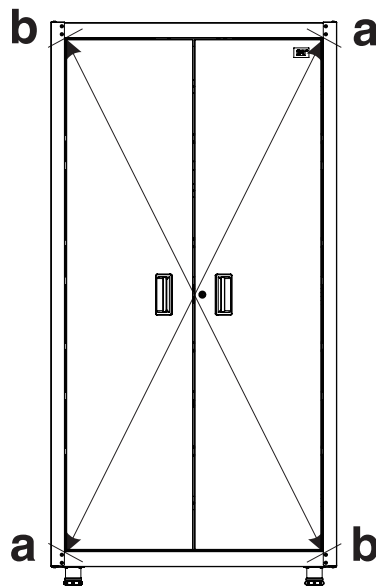

- Close the doors to see if they can touch the magnets completely and are flush with each other. If not, adjust the cabinet's top and side panels to make sure the shape of the cabinet is square and flush (diagonal line $aa=bb$).
- When the doors catch the magnets completely and are flush, tighten all the screws at the cabinet front and back.

8. Connect the cabinet to the wall



WARNING: The M6 x 40 hex tapping bolts (F2) should be drilled into the wall studs.

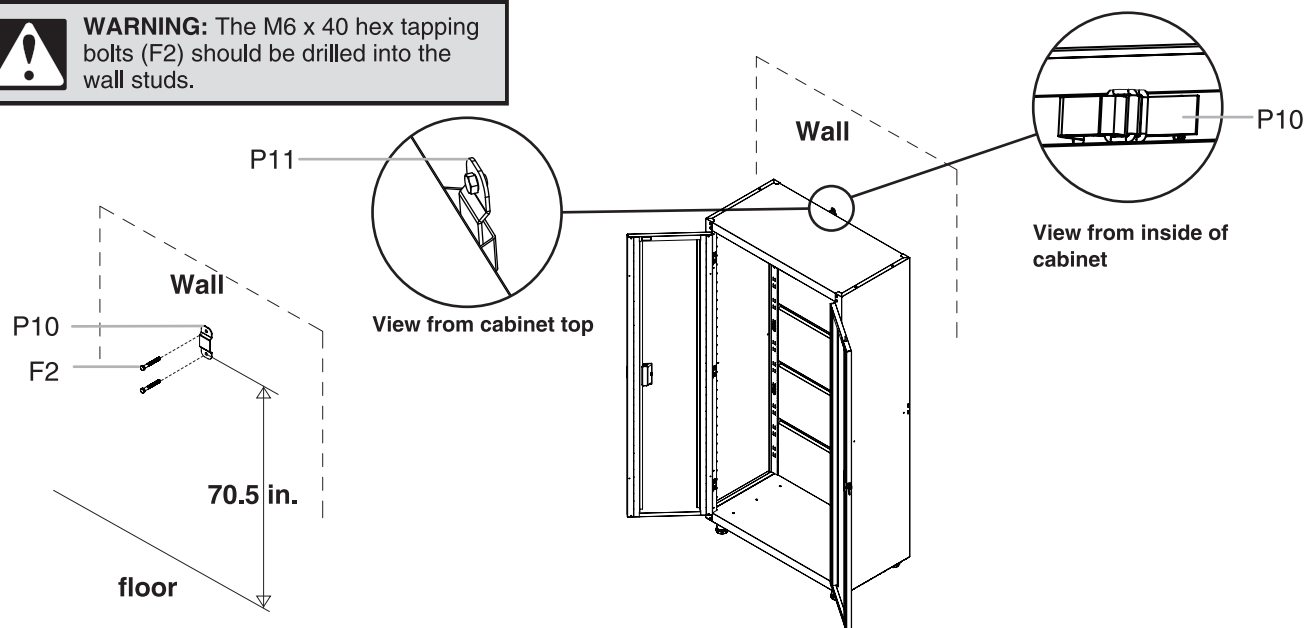

- Install the safety bracket (P11) to the wall stud with two M6 x 40 hex tapping bolts (F2).
- Fasten the tall cabinet by using the safety strap (P10) to tie the tall cabinet and safety bracket (P11) together. Tighten securely.

9. Install the shelves

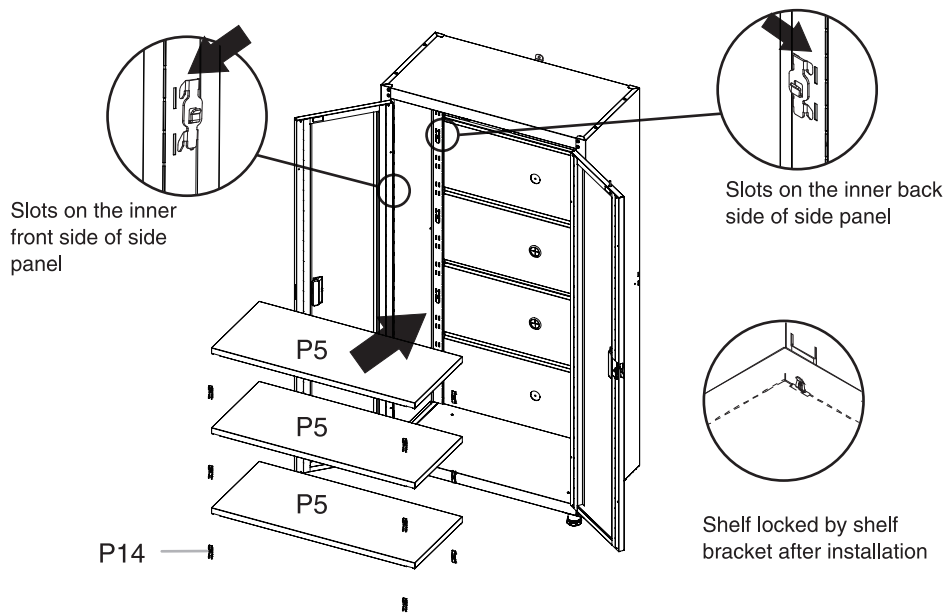

- Insert twelve shelf brackets (P14) into the slots on the side panels at the desired height. Make sure the four brackets for each shelf are at the same height.
- Place the shelves (P5) over the shelf brackets (P14), and push them down onto the shelf brackets (P14).
- Make sure the shelves (P5) are properly and safely locked by the upright hooks of the shelf brackets (P14).

10. Install the grommets

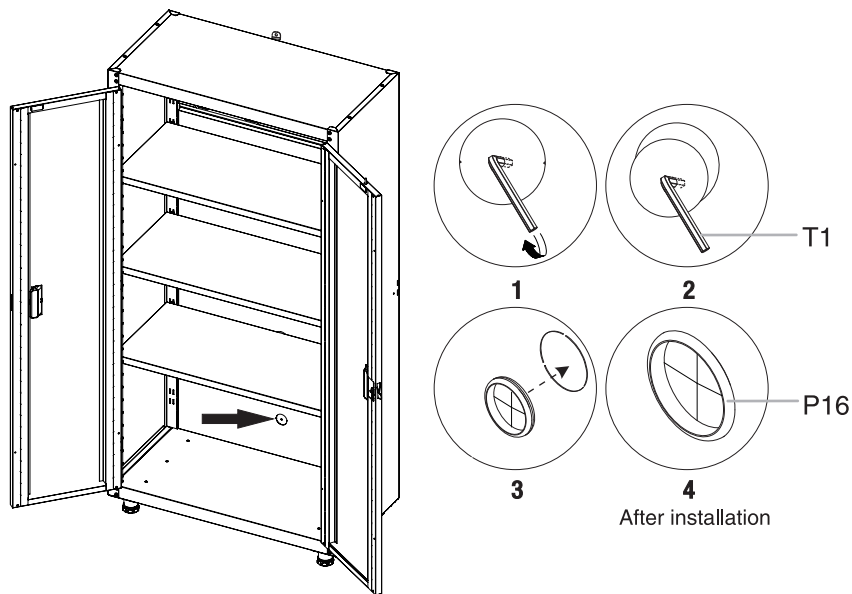

- Insert the short side of the hex wrench (T1) by half into your desired cord access hole, and pry the knock-out towards your side. Take away the knock-out carefully and install the grommet (P16).

MAINTENANCE

Check all the screws and nuts periodically for tightness. Tighten them when necessary.

CARE AND CLEANING

Periodically clean the surfaces with a soft rag and water.

Grease and oil can be removed with most standard cleaning fluids. For safety, use a nonflammable cleaning fluid.



Model:
CAT-GC2802W

28 IN. WALL CABINET

Instruction Manual

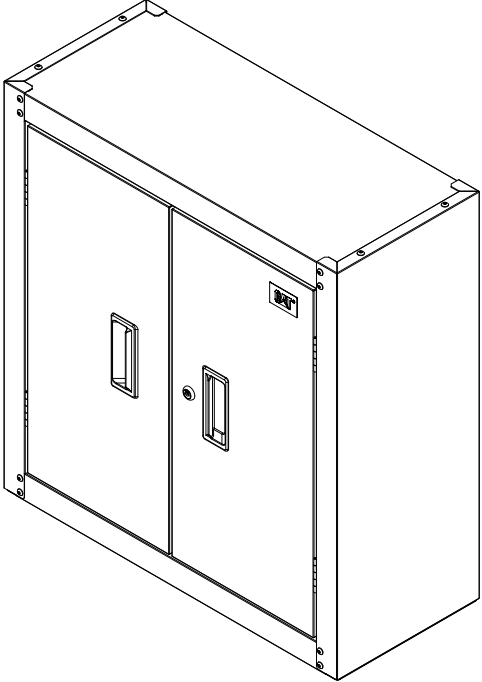

TABLE OF CONTENTS

CABINET SAFETY.....	2	ASSEMBLY INSTRUCTIONS.....	5
DIMENSIONS	3	MAINTENANCE	10
LOAD CAPACITY	3	CARE AND CLEANING.....	10
PARTS.....	4	WARRANTY.....	11
TOOLS REQUIRED FOR ASSEMBLY.....	5		

CABINET SAFETY

Your safety and the safety of others are very important.

We have provided many important safety messages in this manual and on your appliance. Always read and obey all safety messages.



This is the safety alert symbol.

This symbol alerts you to potential hazards that can kill or hurt you and others.

All safety messages will follow the safety alert symbol and either the word "DANGER" or "WARNING."

These words mean:

 **DANGER**

You can be killed or seriously injured if you don't immediately follow instructions.

 **WARNING**

You can be killed or seriously injured if you don't follow instructions.

All safety messages will tell you what the potential hazard is, tell you how to reduce the chance of injury, and tell you what can happen if the instructions are not followed.

To reduce the risk of serious injury, read and follow the safety instructions below before assembling and using this product.

- This product is intended for indoor use only.
- This product is not designed for commercial nor industrial usage.



WARNING: Any assembly or maintenance of the product must be carried out by adults only.



WARNING: Arrange for necessary manpower when assembling, installing and moving the product.



WARNING: Close and lock the door before moving this product.



WARNING: DO NOT alter this product in any manner. For example, do not weld external bar locks or attach electrical equipment. This may cause product damage or personal injury.



WARNING: Keep the product on level surfaces. The product could become unstable and it may tip over if stored or moved on an uneven surface, which may cause personal injury, death or product damage.



WARNING: This product must be securely mounted on wall before using.



WARNING: DO NOT stand on this product. You may fall which may cause personal injury or death.



WARNING: DO NOT put anything on the top panel of this product.



WARNING: Check all nuts and bolts periodically for tightness. When required, tighten them.



WARNING: DO NOT leave children unattended near this product. Cabinet may tip over if improperly opened.



WARNING: Do not exceed the recommended weight limits.



WARNING: Evenly distribute the weight on each level and always keep the heavier loads on the bottom.



WARNING: Before cutting, drilling or hammering into any wall or floor surface, verify the location of electrical, plumbing and gas lines. Cutting may cause serious injury.

DIMENSIONS

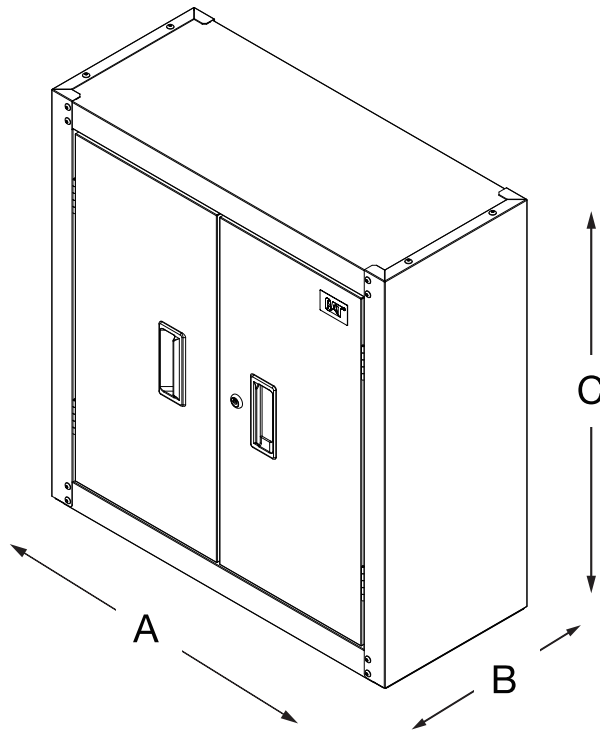

Model	CAT-GC2802W
A	28" (71.3 cm)
B	12" (30.5 cm)
C	29.8" (75.7 cm)

LOAD CAPACITY

Maximum load for shelf	50 lb / 22.7 kg
Maximum load for bottom panel	50 lb / 22.7 kg
Maximum total load	100 lb / 45.4 kg

PARTS

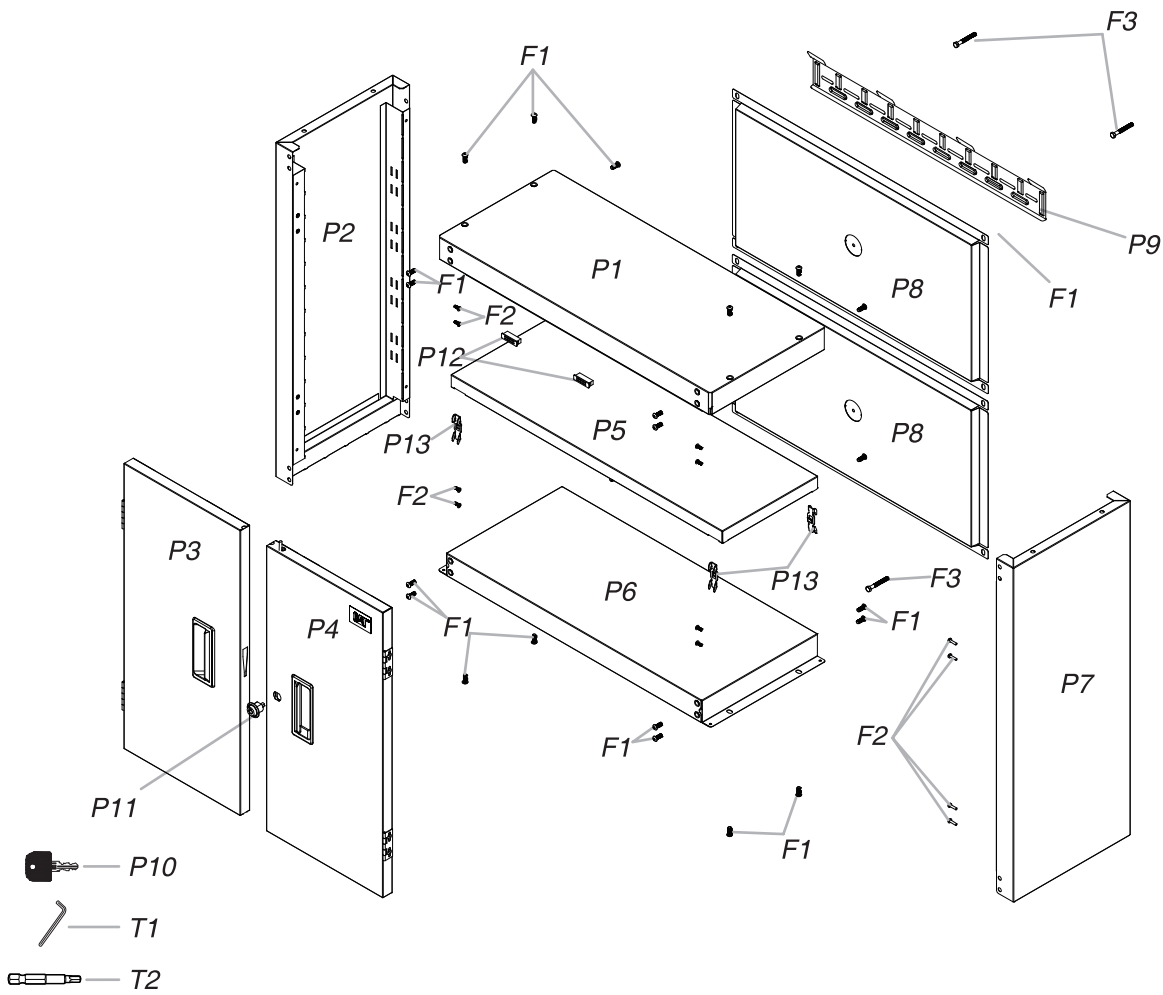

Ref#	Description	Part #	Qty
P1.	Top panel	124768	1
P2.	Left side panel	123860	1
P3.	Left door	124348	1
P4.	Right door	124746	1
P5.	Shelf	245792	1
P6.	Bottom panel	124769	1
P7.	Right side panel	123861	1
P8.	Back panel	245788	2
P9.	Mounting bracket	245797	1
P10.	Key	304196	2

Ref#	Description	Part #	Qty
P11.	Lock	304279	1
P12.	Magnet	312033	2
P13.	Shelf bracket	243311	4
T1.	Hex wrench (hex key)	317023	1
T2.	Hex screwdriver bit	317024	1
F1.	M6 x 16 hex socket head screw	320327	24
F2.	M4 x 12 cross-shaped flat head screw	320084	8
F3.	M6 x 40 hex tapping bolt	320328	4

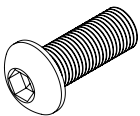

F1

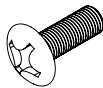

F2

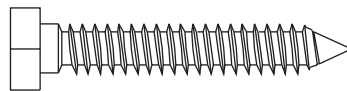

F3

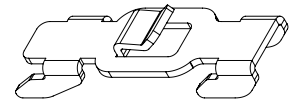

P14

TOOLS REQUIRED FOR ASSEMBLY

Gather the required tools and parts before starting installation.

Tools Needed

- Hex wrench (hex key)
- Hex screwdriver bit (Optional)
- Measuring tape (Not included)
- Power driver (Optional, not included)
- Gloves (Not included)

ASSEMBLY INSTRUCTIONS

1. Attach the top panel

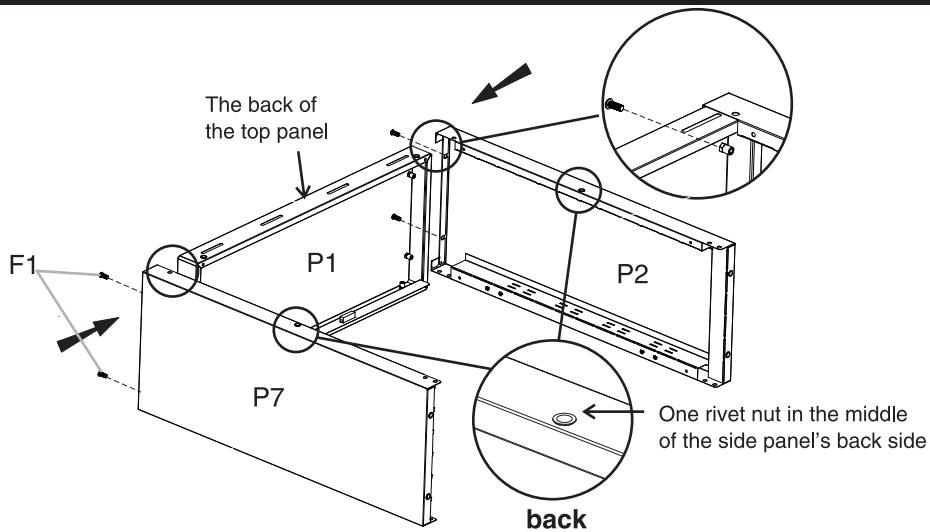

- Attach the top panel (P1) to the side panels' (P2 & P7) top sides with four M6 x 16 hex socket head screws (F1). Tighten securely.

2. Attach the bottom panel

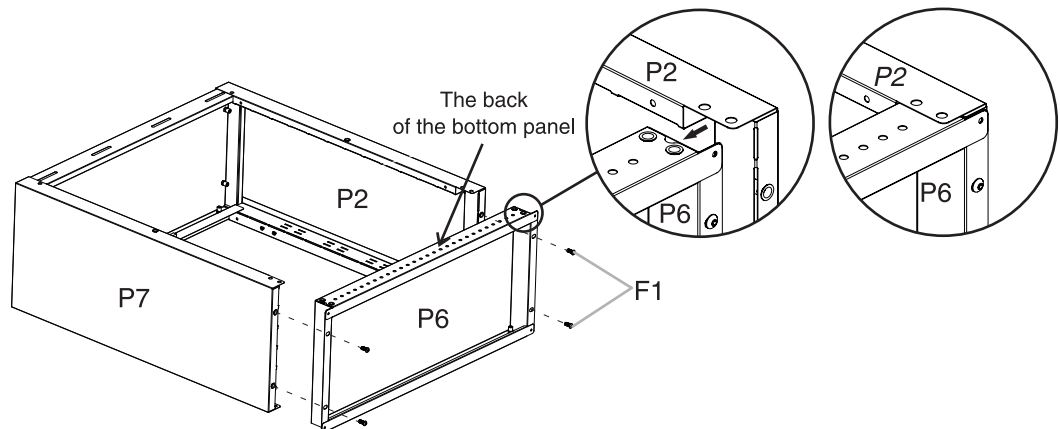

- Attach the bottom panel (P6) to the side panels (P2 & P7) with four M6 x 16 hex socket head screws (F1). Tighten securely.

3. Attach the back panels

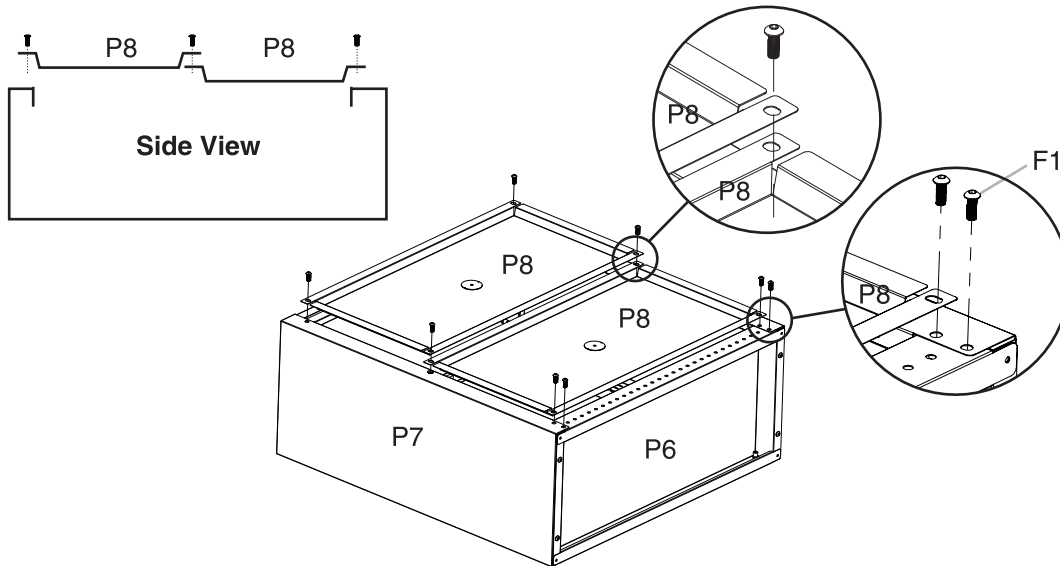

- Attach two back panels (P8) to the back of the cabinet with six M6 x 16 hex socket head screws (F1). Insert the screws by hand. DO NOT tighten.
- Connect the side panels (P2 & P7) and bottom panel (P6) together with two M6 x 16 hex socket head screws (F1). Insert the screws by hand. DO NOT tighten.

4. Connect the top, bottom and side panels

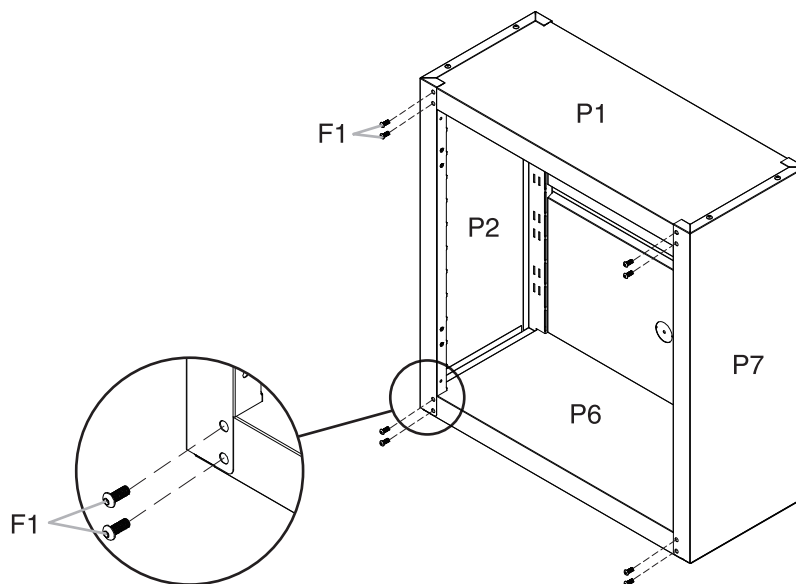

- Stand up the cabinet.
- Connect the top panel (P1), bottom panel (P6) and side panels (P2 & P7) at the front with eight M6 x 16 hex socket head screws (F1). Insert the screws by hand. DO NOT tighten.

5. Attach the doors

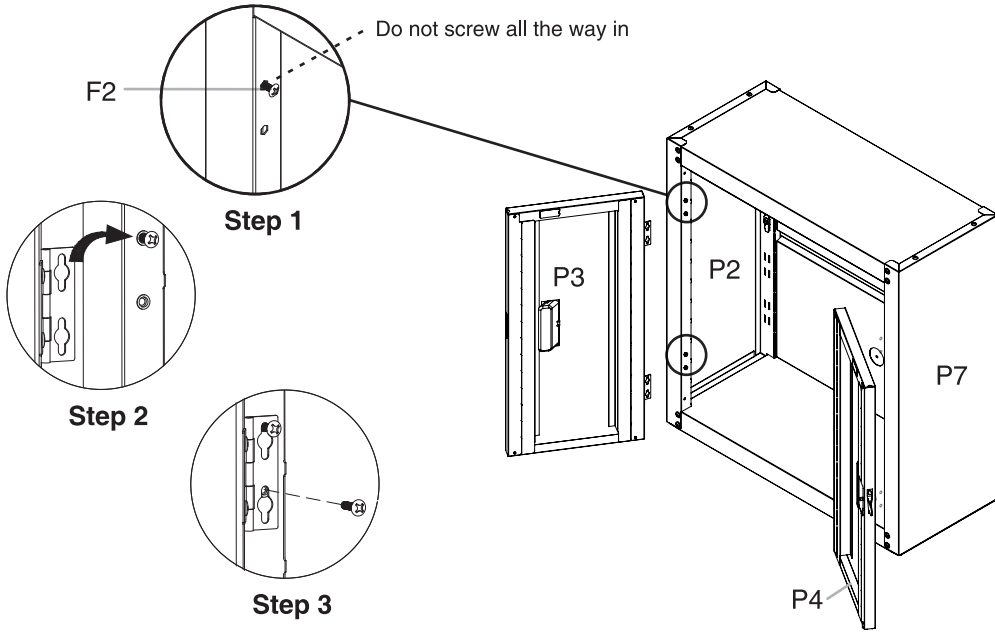

- Screw two M4 x 12 cross-shaped flat head screws (F2) on the inner side of the left side panel (P2), respectively to the top holes of the two hinge locations (circled areas on the drawing). DO NOT screw all the way in.
- Attach the left door (P3) to the left side panel (P2) by hanging the gourd holes of the two door hinges onto the two screws SIMULTANEOUSLY.
- Secure the left door (P3) with another two M4 x 12 cross-shaped flat head screws (F2). Tighten all screws securely.
- Repeat the same procedure to attach the right door (P4).

4. Adjust the cabinet and tighten the screws

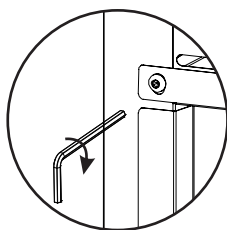

Back

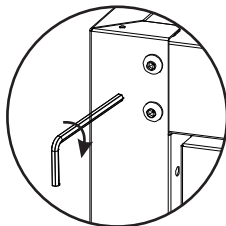

Front

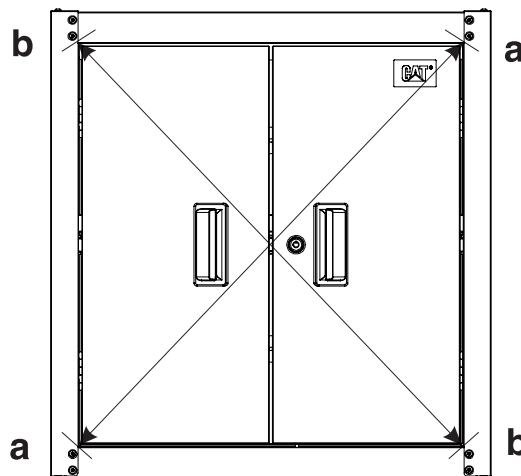

- Close the doors to see if they can touch the magnets completely and are flush with each other. If not, adjust the cabinet's top and side panels to make sure the shape of the cabinet is square and flush (diagonal line $aa=bb$).
- When the doors catch the magnets completely and are flush, tighten all the screws at the cabinet front and back.

7. Install the mounting bracket



WARNING: The M6 x 40 hex tapping bolts (F3) should be drill into the wall studs.



WARNING: The mounting bracket should be level after being installed to the wall.

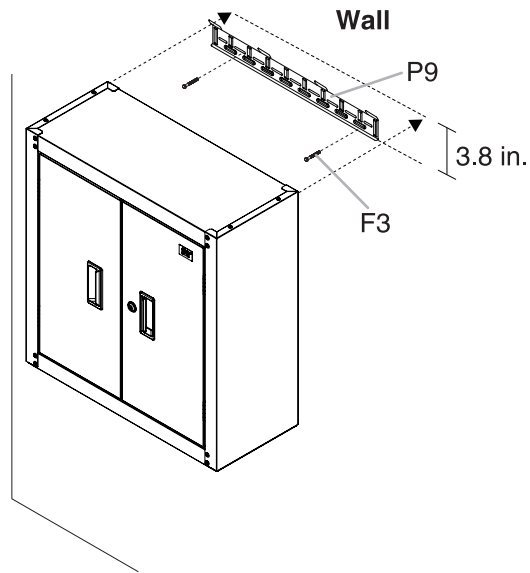

- Decide the location of the wall cabinet on the wall first to find the location of the mounting bracket (P9). The bottom edge of the mounting bracket (P9) should be 3.8 in. away below the cabinet's top edge.
- Install the mounting bracket (P9) on the wall with two M6 x 40 hex tapping bolts (F3).

8. Hang the cabinet



WARNING: Make sure the wall cabinet is securely attached to the mounting bracket (P9).



WARNING: The M6 x 40 hex tapping bolts (F3) should be drilled into the wall studs.

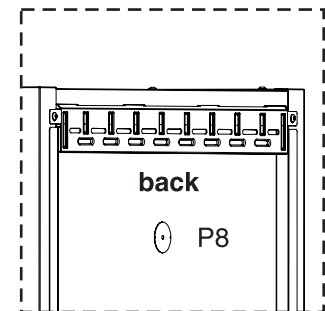
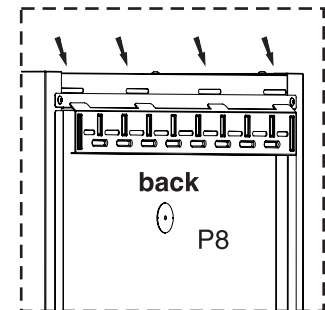
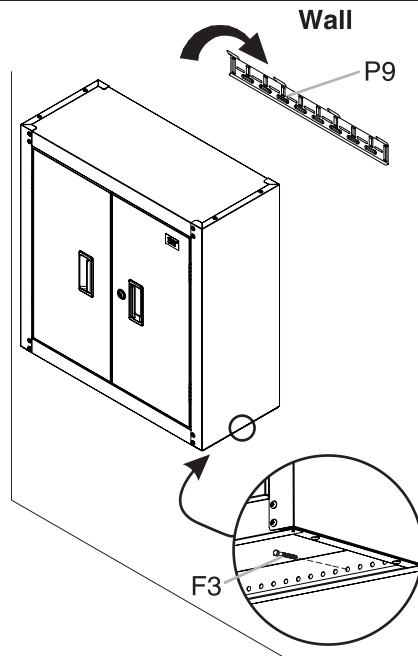

- Hang the wall cabinet onto the mounting bracket (P9).
- Connect the cabinet bottom to the wall with two M6 x 40 hex tapping bolts (F3).

9. Install the shelf

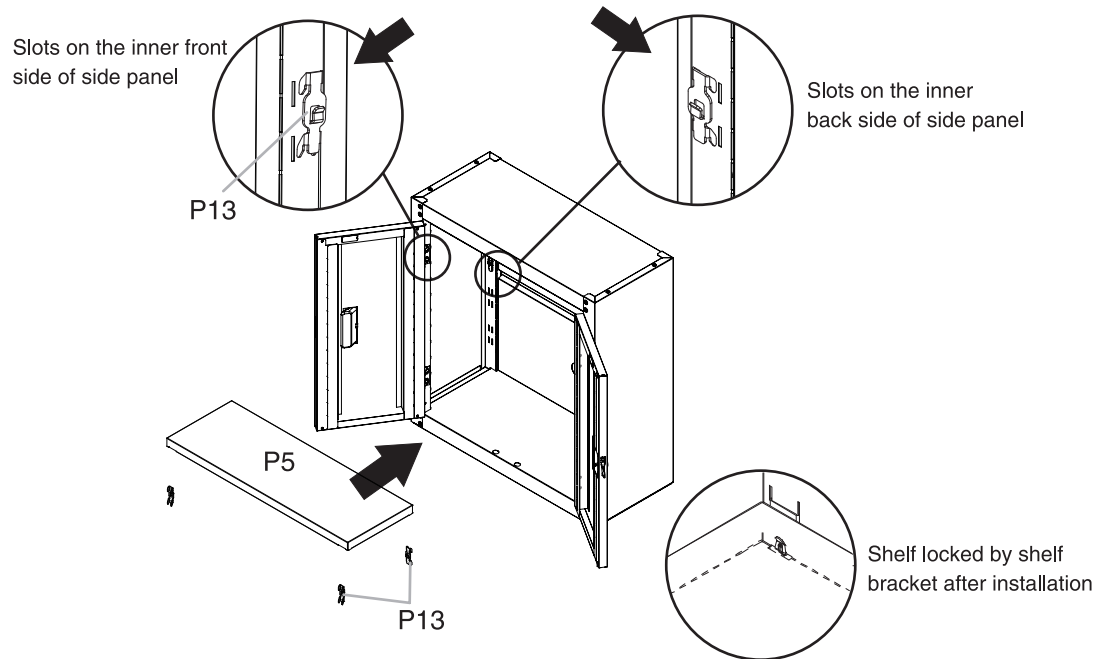

- Insert four shelf brackets (P13) into the slots on the side panels at the desired height. Make sure the four brackets (P13) are at the same height.
- Place the shelf (P5) over the shelf brackets (P13), and push it down onto the shelf brackets (P13). Make sure the shelf is properly and safely locked by the upright hooks of the shelf brackets (P13).

MAINTENANCE

Check all the screws and nuts periodically for tightness. Tighten them when necessary.

CARE AND CLEANING

Periodically clean the surfaces with a soft rag and water.

Grease and oil can be removed with most standard cleaning fluids. For safety, use a nonflammable cleaning fluid.



Model:
CAT-WB7200B

72 IN. WORKBENCH

Instruction Manual



TABLE OF CONTENTS

WORKBENCH	2	ASSEMBLY INSTRUCTIONS.....	5
DIMENSIONS	3	MAINTENANCE	8
LOAD CAPACITY	3	CARE AND CLEANING.....	8
PARTS.....	4	WARRANTY.....	9
TOOLS REQUIRED FOR ASSEMBLY.....	5		

WORKBENCH SAFETY

Your safety and the safety of others are very important.

We have provided many important safety messages in this manual and on your appliance. Always read and obey all safety messages.



This is the safety alert symbol.

This symbol alerts you to potential hazards that can kill or hurt you and others.

All safety messages will follow the safety alert symbol and either the word “DANGER” or “WARNING.” These words mean:

 **DANGER**

You can be killed or seriously injured if you don't immediately follow instructions.

 **WARNING**

You can be killed or seriously injured if you don't follow instructions.

All safety messages will tell you what the potential hazard is, tell you how to reduce the chance of injury, and tell you what can happen if the instructions are not followed.

To reduce the risk of serious injury, read and follow the safety instructions below before assembling and using this product.

- This product is intended for indoor use only.
- This product is not designed for commercial nor industrial usage.
- Solid wood refers to rubber wood.



WARNING: DO NOT alter this product in any manner. For example, do not weld external bar locks or attach electrical equipment. This may cause product damage or personal injury.



WARNING: Check all nuts and bolts periodically for tightness. When required, tighten them.



WARNING: DO NOT leave children unattended near this product.



WARNING: Keep the product on level surfaces. The product could become unstable and it may tip over if stored or moved on an uneven surface, which may cause personal injury, death or product damage.



WARNING: Any assembly or maintenance of the product must be carried out by adults only.



WARNING: Use at least two people to move, assemble or install this workbench. Failure to do so can result in personal injury or product damage.



WARNING: DO NOT sit or stand on the product and do not use it as scaffold.



WARNING: DO NOT allow children to climb, sit or stand on the product.



WARNING: Do not exceed the recommended weight limits.

DIMENSIONS

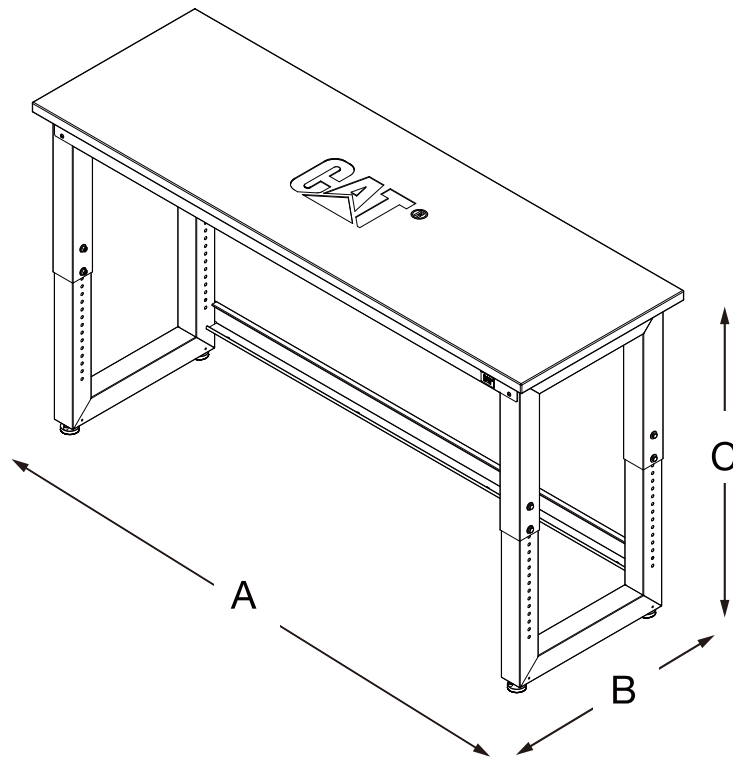

Model	CAT-WB7200B
A	72" (183 cm)
B	24" (61 cm)
C	27.7" - 41.5" (70.3 cm - 105.3 cm)

LOAD CAPACITY

Maximum total load	1500 lb / 680 kg
---------------------------	------------------

PARTS

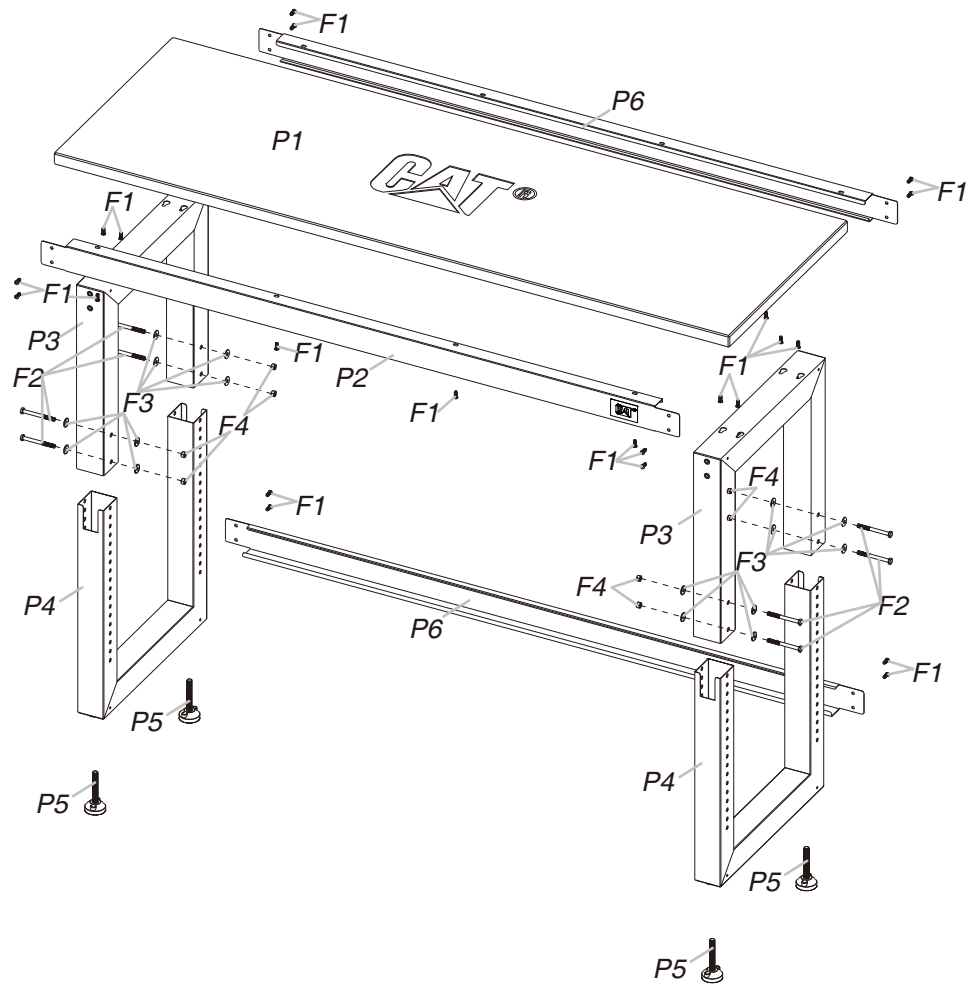

Ref#	Description	Part #	Qty
P1.	Solid wood top	307099	1
P2.	Front stiffener	245233-N01	1
P3.	Upper bench leg	123489	2
P4.	Bottom bench leg	123491	2
P5.	Adjustable foot	313068	4
P6.	Back stiffener	245233	2

Ref#	Description	Part #	Qty
T1.	Hex wrench (hex key)	317035	1
T2.	Hex screwdriver bit	317024	1
F1.	M6 x 16 hex socket head screw	320327	28
F2.	M8 x 85 hex bolt	321212	8
F3.	Washer	324002	16
F4.	M8 hex nut	323074	8

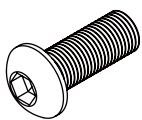

F1

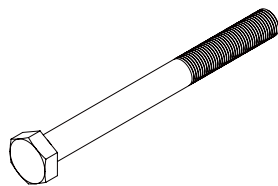

F2



F3

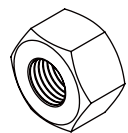

F4

TOOLS REQUIRED FOR ASSEMBLY

Gather the required tools and parts before starting installation.

Tools Needed

- Hex wrench (hex key)
- Hex screwdriver bit (Optional)
- Measuring tape (Not included)
- Power driver (Optional, not included)
- Gloves (Not included)
- Open end wrench (14mm) (Not included)

ASSEMBLY INSTRUCTIONS

1. Attach the upper bench legs to the solid wood top

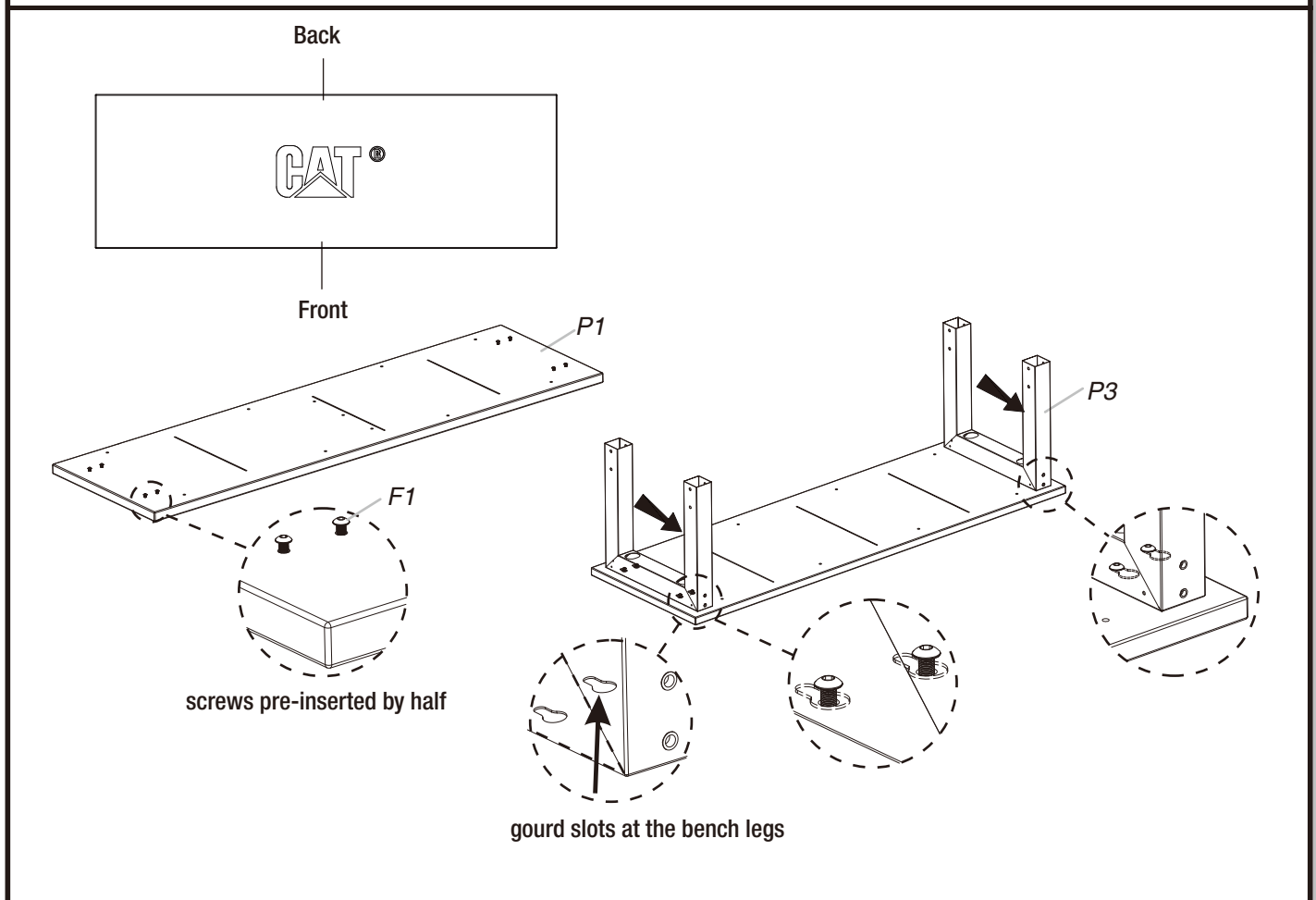

- Lay the wood top on its face. Insert eight M6 x 16 hex socket head screws (F1) BY HALF to the bench leg mounting holes at the bottom of the wood top (P1).
- Put the upper bench legs (P3) onto the half inserted screws (P1) at the wood top through the gourd slots at the bench legs' (P3) top.
- Move the bench legs to make the screws located at the narrow sections of the gourd slots.
- Tighten all the screws.

2. Attach the bottom bench legs

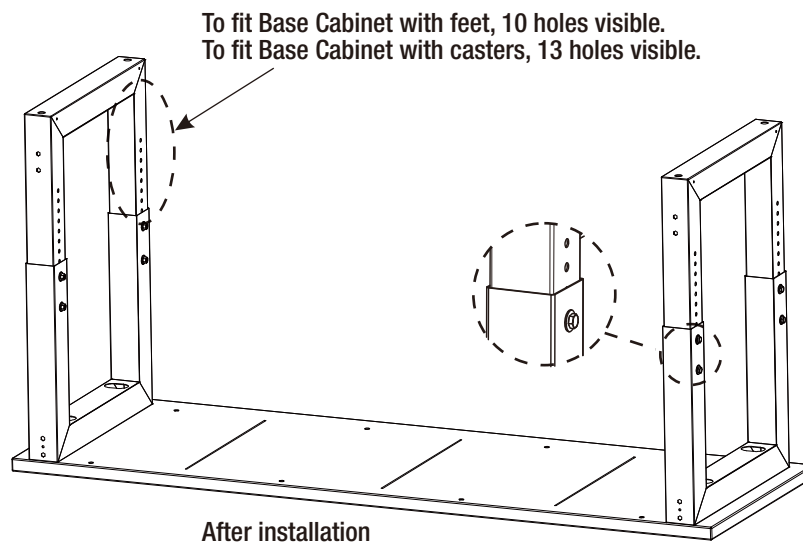
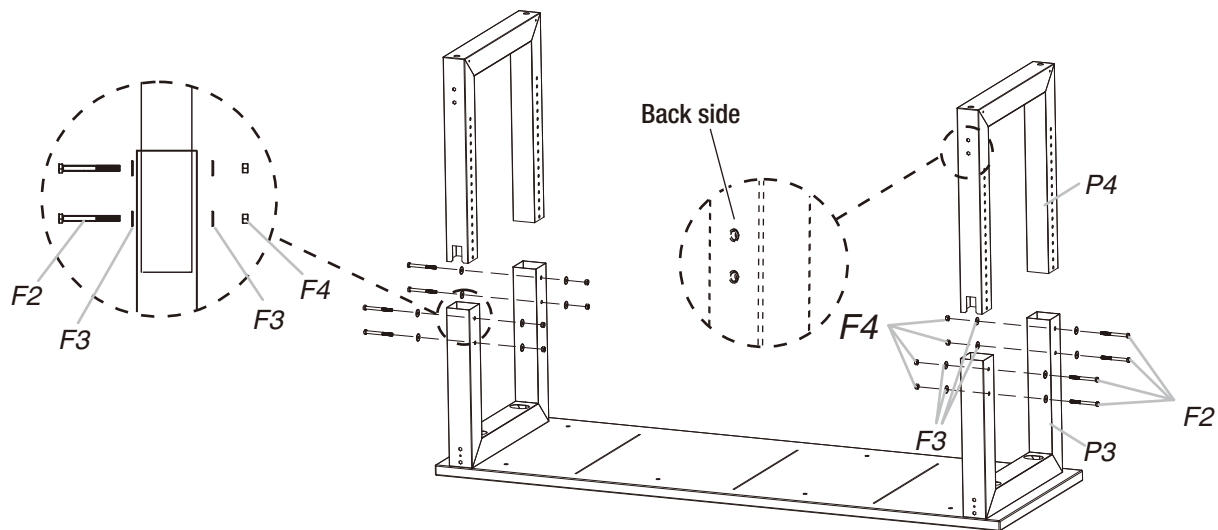

NOTE: The back side of the bottom bench leg is the side with two mounting holes.



NOTE: Two open end wrenches (14 mm) are recommended. One to screw the bolt, and another one to hold the nut while screwing the bolt.



NOTE: CAT 28" Base Cabinets with feet can be put under the Workbench. The Workbench should be at a height where at least 10 holes in each bottom bench legs visible.



NOTE: CAT 28" Base Cabinets with casters can be put under the Workbench. The Workbench should be at a height where 13 holes in each bottom bench legs visible.

- Insert the bottom bench legs (P4) into the square holes of the upper bench legs (P3).
- Adjust the height of the bottom bench legs (P4) to a desired height. Adjust from 27.7 in. to 41.5 in. in 1 in. increments.
- Attach the upper and bottom bench legs (P3 & P4) together with eight M8 x 85 hex bolts (F2) and washers (F3) in the holes of the bench legs (P3 & P4). Insert a washer (F3) and a M8 hex nut (F4) onto the end of each M8 x 85 hex bolt (F2). Tighten securely.

3. Attach the front stiffener

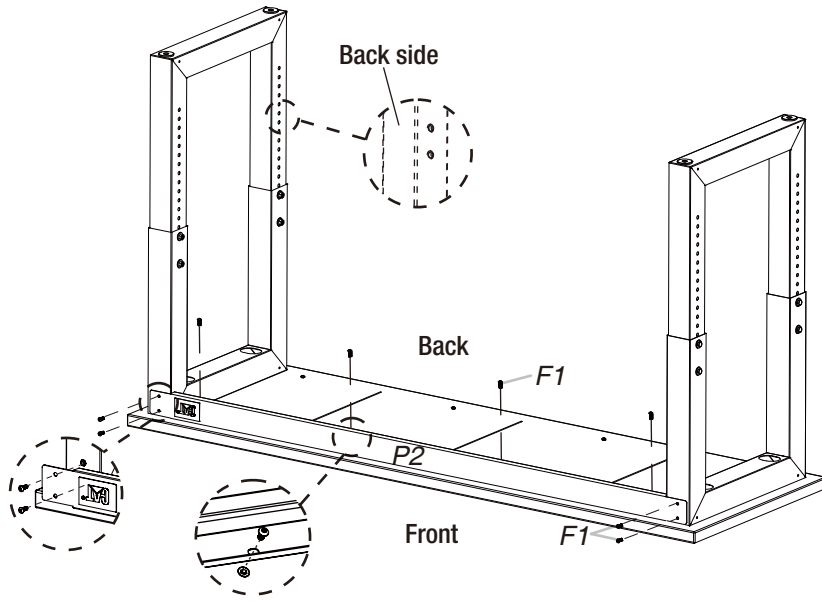

- Attach the front stiffener (P2) to the front top of the workbench with eight M6 x 16 hex socket head screws (F1). Tighten securely.

4. Attach the back stiffeners

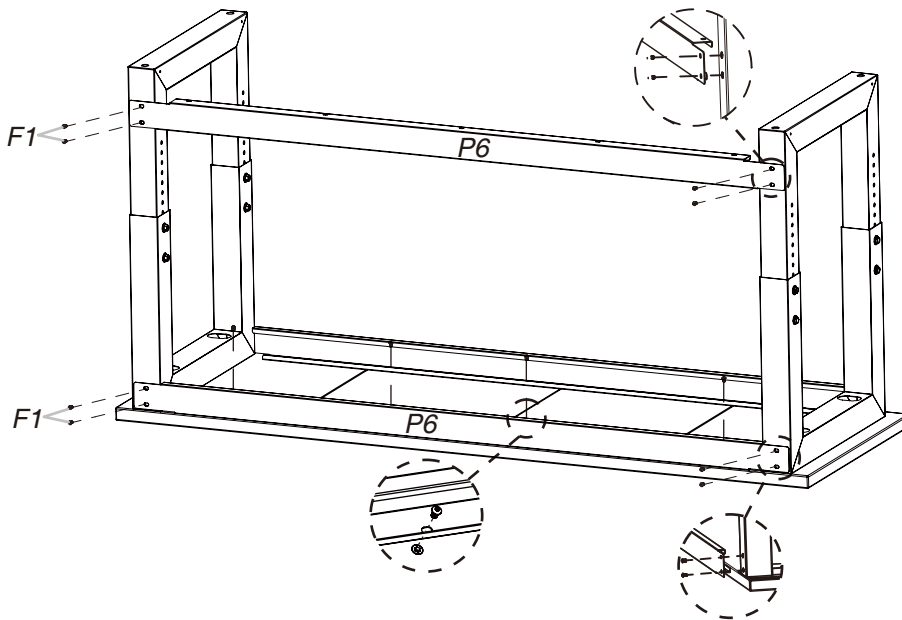

- Attach the back stiffeners (P6) to the back of the workbench with twelve M6 x 16 hex socket head screws (F1). Tighten securely.

5. Install the adjustable feet

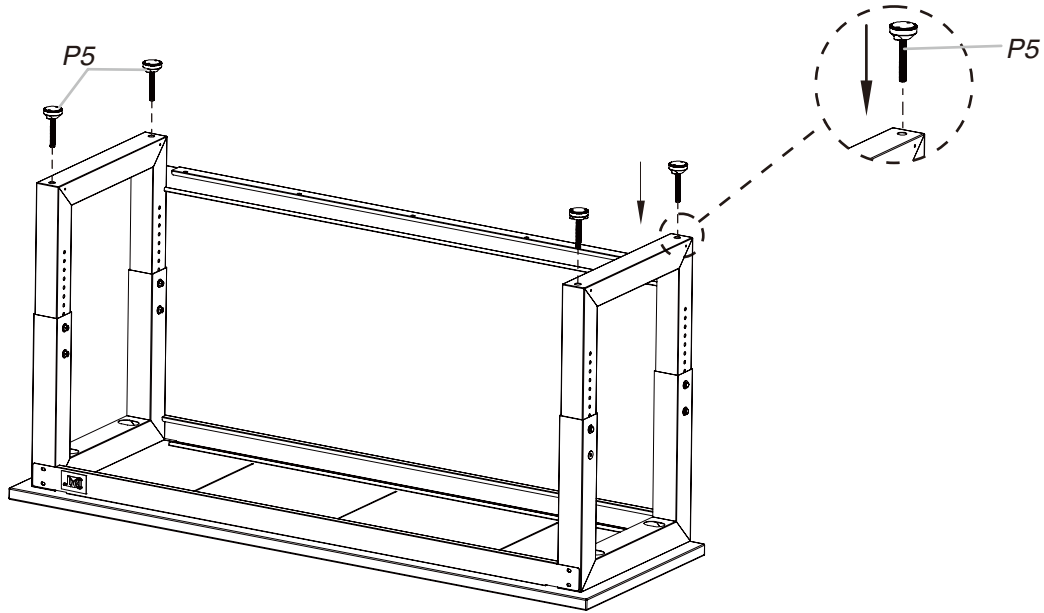

- Screw the adjustable feet (P5) into the holes in the bottom bench legs (P4).

6. Stand up the workbench

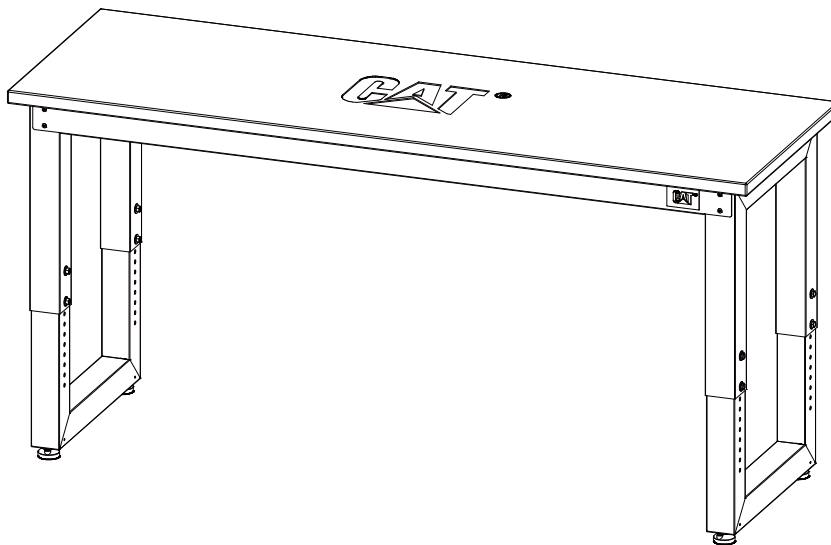

- Stand up the workbench and place it on the desired level floor. Adjust the feet if necessary to make the workbench stable.

MAINTENANCE

Check all the screws and nuts periodically for tightness. Tighten them when necessary.

CARE AND CLEANING

Periodically clean the surfaces with a soft rag and water.

Grease and oil can be removed with most standard cleaning fluids. For safety, use a nonflammable cleaning fluid.

Warranty

Manufacturer Warranty Limited One Year

When this product is installed, operated and maintained according to the instructions attached to or furnished with the product, warranty covers the replacement of the defective product or parts if the part fails as a result of defective materials or workmanship for the one year of the product. For assistance, call **1.888.873.8071** between **8:00 AM - 4:00 PM EST, Monday-Friday** www.catgaragestorage.com

Warranty does not cover:

1. Service calls to correct the installation.
2. Damage resulting from improper handling, or products damaged by accident, misuse, abuse, fire, flood, improper installation, acts of God, neglect, corrosion, modification or mishandling.
3. Products damaged by improperly loading beyond the specified maximum weight capacity outlined in the instructions provided with the product.
4. Repairs or replacement when your product is used in other than normal, single-family household use, such as a commercial environment, or handled in anyway inconsistent with the installation instructions included with the product.
5. Cosmetic damage, including scratches, dings, dents or cracks in paint that do not affect the structural or functional capability of the product.
6. Surfaces damaged due to chemical interaction resulting in corrosion of paint or metal.
7. Replacement parts for products outside Canada.
8. Loss of product contents due to theft, fire, flood, accident or acts of God.
9. Shipping or freight fees to deliver replacement products or to return defective products.
10. Any labor costs during the limited warranty period.

DISCLAIMER OF IMPLIED WARRANTIES; LIMITATION OF REMEDIES

IMPLIED WARRANTIES, INCLUDING TO THE EXTENT APPLICABLE WARRANTIES OF MERCHANTABILITY OR FITNESS FOR A PARTICULAR PURPOSE, ARE EXCLUDED TO THE EXTENT LEGALLY PERMISSIBLE. ANY IMPLIED WARRANTIES THAT MAY BE IMPOSED BY LAW ARE LIMITED TO ONE YEAR, OR THE SHORTEST PERIOD ALLOWED BY LAW. SOME STATES AND PROVINCES DO NOT ALLOW LIMITATIONS OR EXCLUSIONS ON HOW LONG AN IMPLIED WARRANTY OF MERCHANTABILITY OR FITNESS LASTS, SO THE ABOVE LIMITATIONS OR EXCLUSIONS MAY NOT APPLY TO YOU. THIS WARRANTY GIVES YOU SPECIFIC LEGAL RIGHTS, AND YOU MAY ALSO HAVE OTHER RIGHTS WHICH VARY FROM STATE TO STATE OR PROVINCE TO PROVINCE



© 2025 Caterpillar. All Rights Reserved. CAT, CATERPILLAR, LET'S DO THE WORK, their respective logos, "Caterpillar Corporate Yellow", the "Power Edge" and Cat "Modern Hex" trade dress as well as corporate and product identity used herein, are trademarks of Caterpillar and may not be used without permission.

846856 Ontario Inc, a licensee of Caterpillar Inc.